PROLOGUE

Thanking you for your purchase our products sincerely, please reading the manual book before operation, the book introduce some points how to operate, maintenance, and safe. Please keep it carefully for reading in the further; you will be not informed if the file has been revised. Please set sample as standard.

CONTENTS

TO THE OPERATORS	1
HOW TO INSTALL THE NEW MACHINE	1
LUBRICATION AND DRAINAGE	2
THREADING THE MACHINE	3
THREAD TENSION	3
STITCH LENGTH ADJUSTMENT	5
NEEDLE REPLACENENT	5
DIFFERENTIAL FEED RATION ADJUSTMENT	6
PARTS RELATION AND TIMING	6
PROBLEM SETTLEMENT	9
ALL RARTS OF THE COMPONENTS	13-50
SPECIAL PIECE	51



OBSERVE THESE SAFETY PRECAUTIONS

Though Our takes the utmost care to produce safe sewing machines and devices, operators should follow these basic safety rules.

- To prevent accidents, do not remove safety devices or parts while operating the machine.
- Do not leave tools or other unnecessary objects on the machine table while operating the machine.
- Before maintenance, adjusting, cleaning, threading or replacing the needle, and to prevent accidents, be sure the power is turned off. Check that the machine will not operate when the pedal is pressed.

Note

In case a clutch type motor is used, it will keep on rotating by inertia after turning off power supply. ① If the machine pedal ② is stepped on inadvertently, it is dangerous because the machine will move unexpectedly. Keep on stepping on the pedal ② until the machine comes to a stop after turning off power supply.

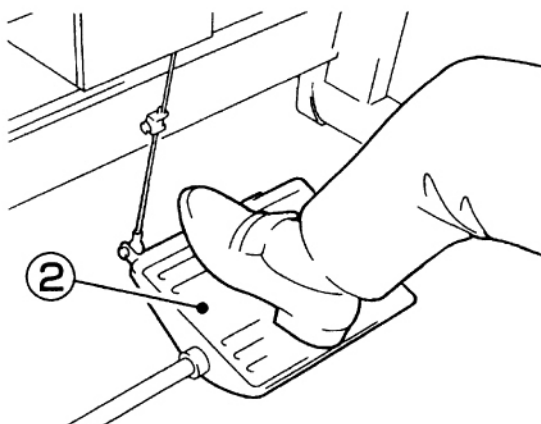
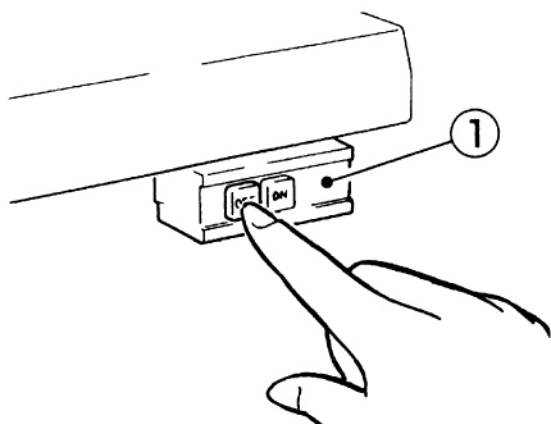

- Turn the power off before leaving the machine table.
- In the event of a power failure, be sure to turn the machine off.
- Check that the machine is securely grounded.

TO THE OPERATORS

ATTENTION: Because this is an super high speed machine. DO not run it before filling. Oil and/making sure the correct turning direction of motor.

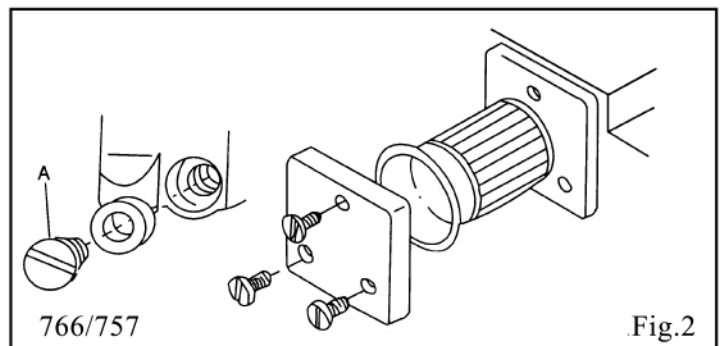
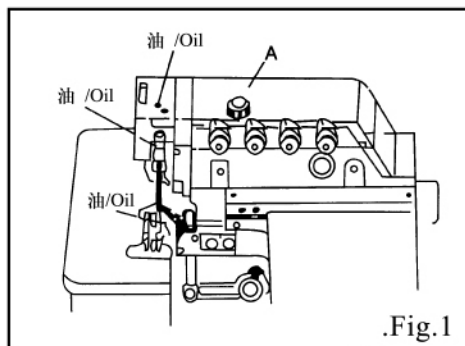
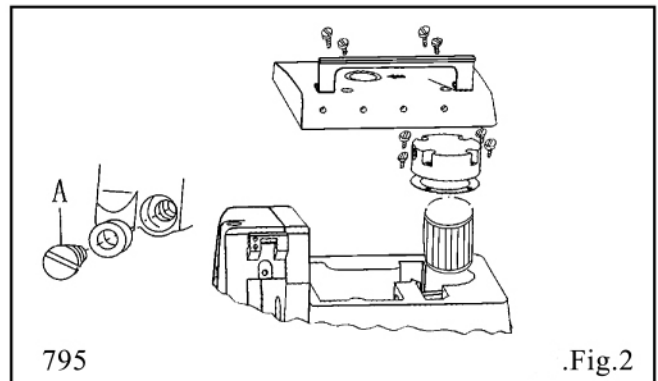
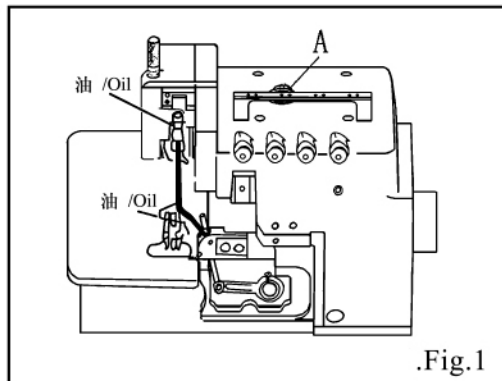

HOW TO INSTALL THE MACHINE

- (1) Install the machine according to the table cut-out diagram, Cushion Rubber and Rest Board as enclosed. In case of semi-submerged, the distance between Needle plate top surface and Table Top is about 100mm, and for fully-submerged is about 5mm.
- (2) Setting the pedal of clutch motor to the left side and the pedal of presser foot lift at right ride.
- (3) Install the cloth waste chute, thread stand as parts list.
- (4) Be sure the motor turning direction is clockwise. And the belt can be pressed inware about 10mm.

NOTE: The dimensions of motor pulley and sewing speed are show in Table 1.

Tab.1

Machine speed (S.P.M)	Motor pulley diameter (mm)	
	60Hz	50Hz
5500	90	110
6000	95	115

HOW TO OPERATE THE NEW MACHINE

Please run the new machine in the first four at 20% less speed than maximum. Then replace the new oil and thereafter the machine may be operated up to maximum speed.

LUBRICATION AND DRAINAGE

(1) Lubrication Fig.1

·Remove Screw A and fill in enclosed ultra high speed lubricate oil (or similar to Mobil# 10,Esso#32) until the oil surface between two lines of oil Level Sight Window , Then replace Screw A.

·When the machine is operated for the first time it was idle for a long time ,please be sure to oil the top of the needle holder , guide , upper looper guide etc. before operating the machine.

(2) Drainage Fig.2

·Remove Screw A and drain out the oil then replace Screw A.

·For keeping the good lubrication and machine life. please replace the new oil when the new machine has been operating over four weeks, And after that , change oil every four months.

·This machine has been fixed with oil filler .please clean it every month or replace a new one if necessary .

(3) Needle Cooling Lubrication-Silicon oil.

THREADING THE MACHINE FIG3.4

Refer to the sewing type you need for correct threading. Any incorrect threading may cause thread break, uneven stitches or skip stitches etc.

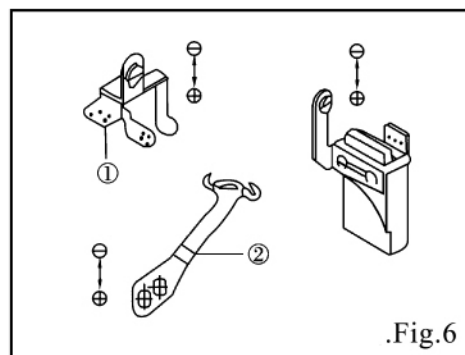
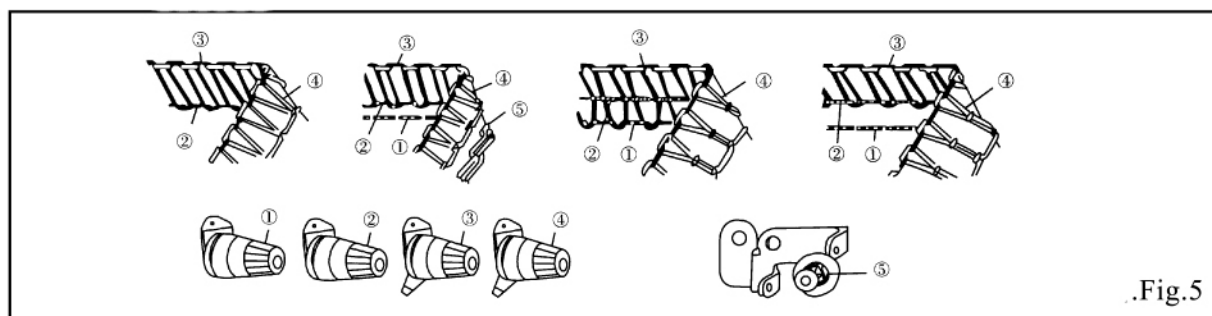
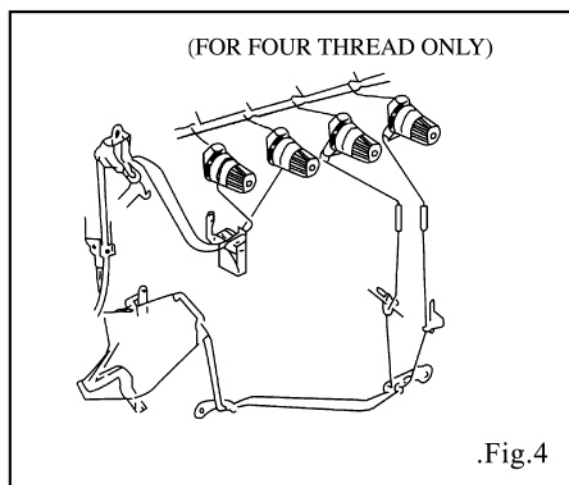
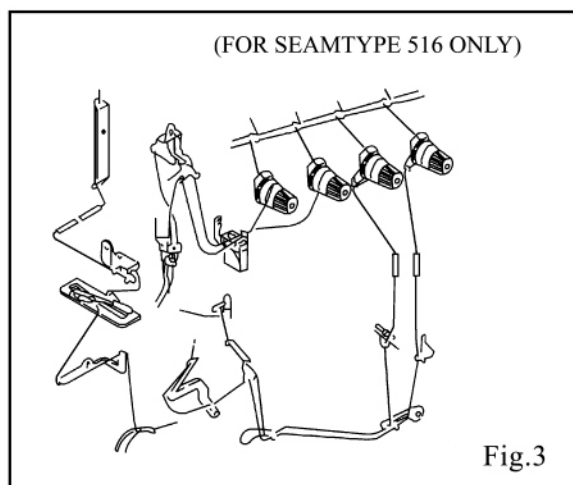

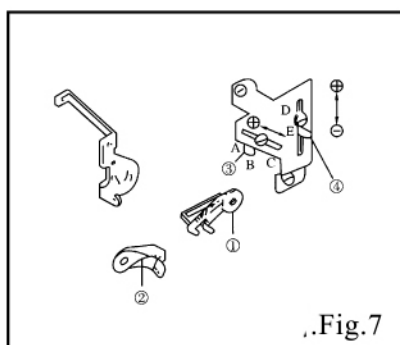

..Fig.7

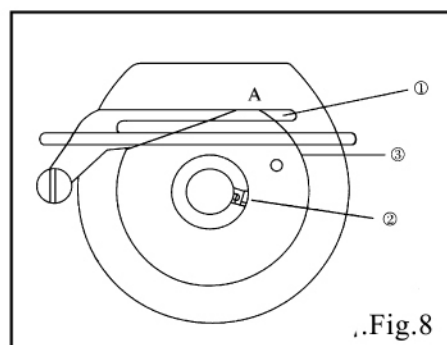

..Fig.8

THREAD TENSION

The thread tension be adjusted according to sewing fabric, thickness, sewing thread, seam width stitch length etc. Therefore the pressure of the Tension Nuts or Thread Guides must be adjusted in each individual case.

(1) Tension Nut Adjustment.Fig.5

- The tension Nut ① controls the double chain needle thread or left side overlock needle thread.
- The Tension Nut ⑤ controls the double chain looper thread.
- The Tension Nut ② controls the overlock needle thread.
- The Tension Nut ③ controls the upper looper thread.
- The Tension Nut ④ controls the lower looper thread.

(2) Needle thread control.Fig.6

·In case of sewing type 504, 512, & 514, push thread guide ① and ② to lowest point. and up to highest point of sewing type 503,505.

Note: the ⊕ direction is for more needle thread tension, otherwise it is for less needle thread tension.

(3) Looper thread control.Fig.7

·For sewing type 512, when upper looper is extremely left, push take-up ① and ② at the position as the chain line.

·In case of sewing type 503 and 505, when upper looper moves to lowest, set take-up ① and ② at the position as the continuous line.

·Adjust thread guide ③ as follows:

- a) Point A for stretchy thread is used.
- b) Point B for seaming and blind stitch hemming.
- c) Point C for seaming type 512.

·Adjust thread guide ④ as follow,

- d) Point D for stretchy thread is used.
- e) Point E for seaming and blind stitch hemming.

Note: The direction is for more thread in sewing seam, and the direction is for less thread in sewing seam.

(4) Chain looper thread cam control.Fig.7

When the needle moves to its highest position, the right corner of the thread cam ③ matches with the upper surface of thread guide bracket ①.

Screw ② and adjust the thread cam ③ as clockwise is late for timing of looper thread cam.

STITCH LENGTH ADJUSTMENT FIG.9TAB2

The stitch length adjustment is made according to the sewing fabric , differential feed ratio etc.

- Keep pushing the Push Botton enter deep inside .
- Keep pressing the Push Botton and match the desired stitch length which is show on the pulley with the indicating point of Belt Cover.

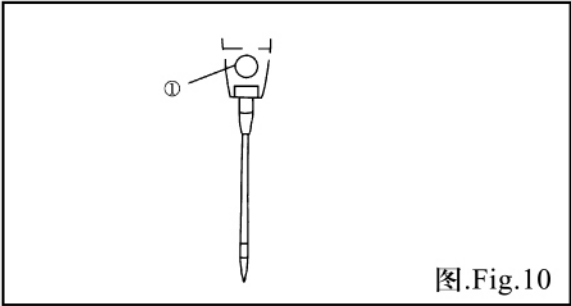
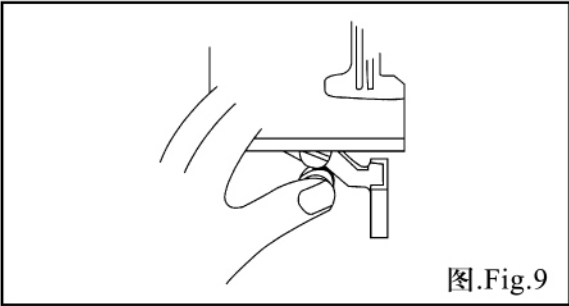

Tab.2

Maxi diff ratio	Machine type	Pulley scale						
		1	2	3	4	5	6	7
1:2	Seaming	1	1.5	2	2.5	3	3.5	3.8
1:3	Shirring	0.7	1	1.4	1.7	2	2.3	2.5
1:1.3	Serging	1.6	2.3	3.1	3.9	4.7	5.4	5.9
1:4	Special	0.6	0.9	1.2	1.5	1.8	2.1	1

NEEDLE REPLACEMENT FIG.10

- Please use DC × 27 or equivalent needle size.
- Loosen Screw ① and remove the old needle .
- Insert the needle which long groove faces you and push it up deep into the needle hole until it stops and tighten Screw ① .

DIFFERENTIAL FEED RATIO ADJUSTMENT(FIG.11TAB.3)

The differential feed ratio is the ratio of movements between Main Feed Dog and Differential Feed Dog , when the movement of Main Feed Dog is bigger than Differential Feed Dog , the fabric be stretched in sewing Otherwise the fabric be shrinked.

- Loosen Nut ① then turn Screw ② in clockwise for stretching the fabric. and in reverse direction for shrinking the fabric then tighten Nut ① .

NOTE: When the surface of adjusting Level ③ be set at the scale ② the differential feed ratio is 1:1, and if it be set over the scale its ratio can be adjustable up to 1:0.7 .

Tab.3

Scale		1	2	3	4	5
Differential Feed ratio	1:3	---	1:0.7	1:0.9	1:1.1	1:1.3
	1:2	1:0.7	1:1	1:1.4	1:1.7	1:2
	1:3	1:1	1:1.5	1:2	1:2.5	1:3
	1:4	1:1.1	1:1.6	1:2.3	1:2.8	1:3.3

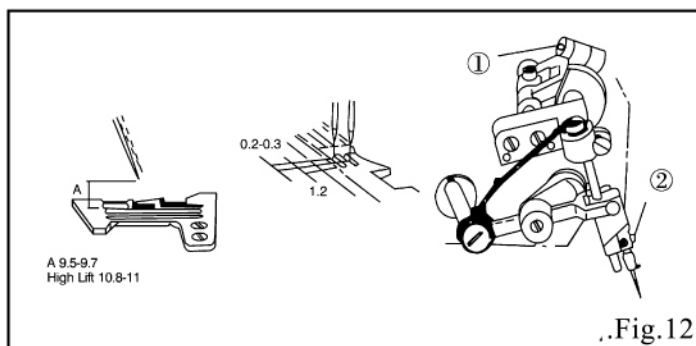
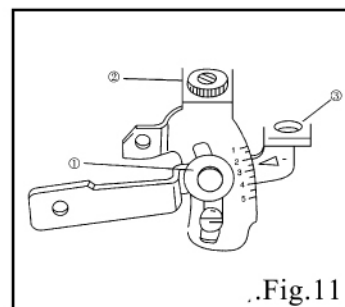

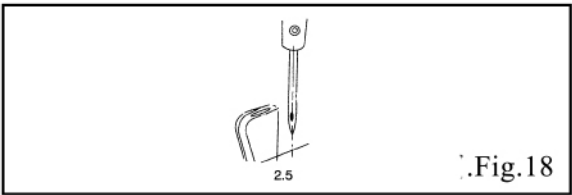
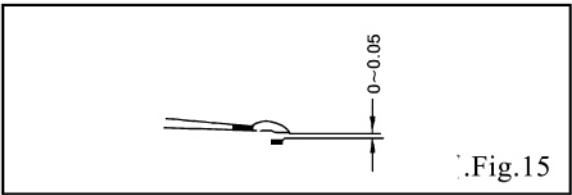
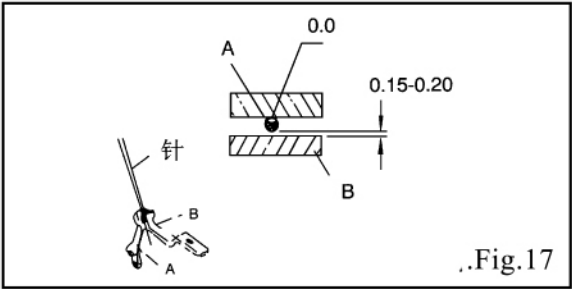
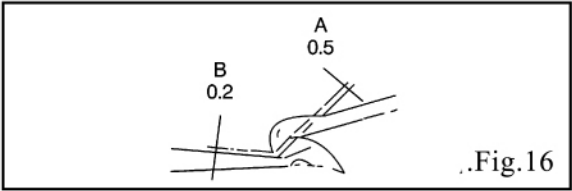
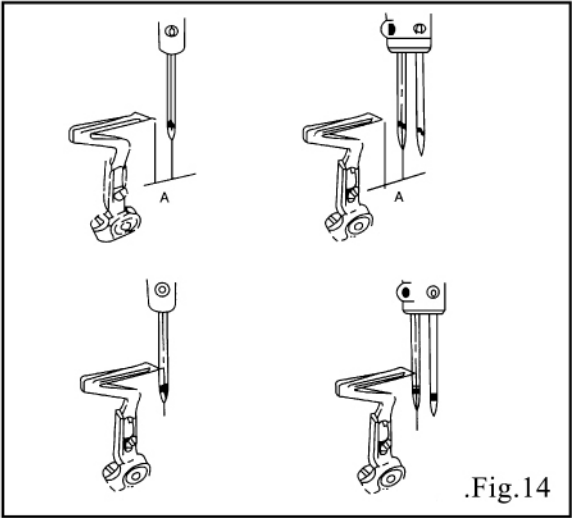
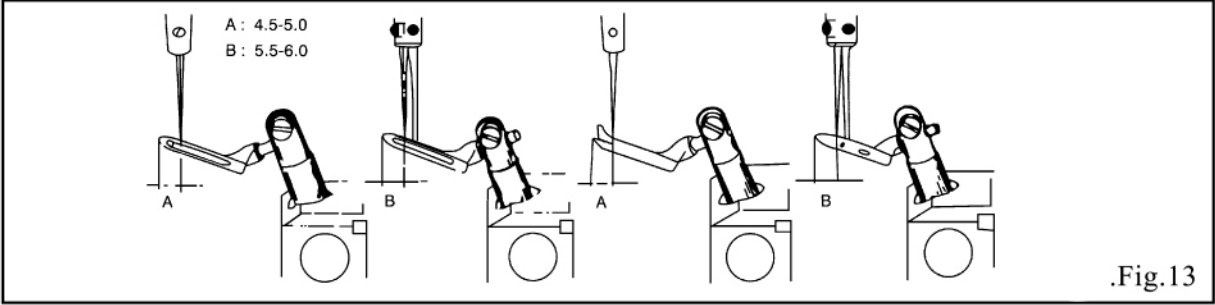

PARTS RELATION AND TIMING

(1) Needle and Needle Plate Fig.12

When the Needle moves to the highest position, the distance between needle point (left needle if two needle) and Needle Plate is 9.5-9.7mm for standard lift machine or 10.8-11.0mm for high lift machine. Each needle must center in each needle slot of Needle plate. The right needle must be ahead about 0.2-0.3mm than left needle. And the distance between the needle point (right needle if two needle).

To needle slot of Needle Plate or Presser Foot is 1.2mm.

- Slightly loosen Screw ① of Needle Drive Crank.
- Rotate the Pulley to check if needle center in each needle slot of Needle Plate. or you may loosen Screw ② and adjust Needle Holder .
- Rotate the Pulley for removing the needle to the highest position , tap the Needle Holder Guide until the correct needle height is obtained .
- Tighten Screw ① .

(2) Upper Looper (Spreader) and Needle Fig.13

·When the Upper (spreader) moves to the extremely left, the distance between the point of looper (spreader) and center line of needle is 4.5-5.0, for 1 needle (spreader) to center line of left needle is 5.5-6.0mm for 2 needle machine.

(3) Lower Looper and Needle Fig.14.15

·When the Lower Looper moves to the extremely left, the distance between looper point and center line of needle (left needle if 2 needle) is 3.4-3.6mm for high lift machine.

·When the Lower Looper moves to the center line of needle (left needle if 2 needle), the gap between needle and looper is 0-0.05mm.

(4) Upper Looper and Lower Lopper Fig.16

When the Upper and Lower Lopper is crossed.

(5) Needle and Needle Guard Fig.17

When the Lower Looper point is opposite the center line of Needle (left needle if 2 needle) , the gap between Needle and rear Needle Guard A is 0mm. when Needle moves to the lowest position, the gap between Needle and front Needle Guard B is 0.15-0.2mm.

(6) Chain Looper and Needle Fig.18

The Chain Looper must be fixed into the lowest position of its holder and when the Chain Looper moves to the extremely left, the distance between the looper point and center line of needle is 2.5mm.

NEEDLE BREAK

NO.	REASON	CORRECT
1	Needle installed wrong	Reset needle correctly
2	Wrong needle size	Use properly needle for fabric and thread
3	Needle is bended	Replace new needle
4	Wrong relation with Needle Guars	Readjust Needle Guard
5	Wrong relation with looper	Readjust looper
6	Needle does not center the needle slot of needle Plate or Presser Foot	Readjust the needle plate and presser point

THREAD BREAK

NO.	REASON	CORRECT
1	Inferior quality of thread	Use good quality thread
2	Thread is thicker than Needle hole	Use proper Needle for fabric and thread
3	Wrong threading	Rethreading correctly
4	Thread tension is too strong	Readjust thread tension nut
5	Needle installed wrong	Reset needle correctly
6	Thread Stand installed wrong	Reset thread stand for threading smoothly
7	Over heat of Needle: (1).NO silicon oil (2)Wrong setting of Needle Guard	(1)fill in Silicone oil (2) Readjust Needle Guard
8	Thread Disc or Guide is burred	Grind off polish or replace new one
9	Wrong relation of Needle and Looper	Readjust Needle and Looper
10	Needle, Looper, Needle Plate and Guide is burred	Grind off , polish or replace new one

SKIP STITHCES

NO.	REASON	CORRECT
1	Wrong relation of Needle and Looper	Readjust Needle and Looper
2	Wrong threading	Rethreading correctly
3	Needle installed wrong	Reset Needle correctly
4	Inadequate thread tension or tension too strong	Readjust Thread Tension Nut
5	Looper point is damaged	Replace new one
6	Needle is bended	Replace new one
7	Wrong installed Needle Guard	Readjust Needle Guard

LOOSEN STITCHES

NO.	REASON	CORRECT
1	Wrong threading	Rethreading correctly
2	Thread is thicker than Needle hole	Use proper Needle
3	Tension Disc do not press thread properly	Reset Tension Disc Properly
4	Needle thread is not lubricated	Fill silicon oil
5	Wrong setting of Needle and Loopers	Readjust Needle and Loopers

UNEVEN STITCHES

NO.	REASON	CORRECT
1	Wrong threading	Rethreading correctly
2	Thread Stand installed wrong	Reset Thread for threading smoothly
3	Lower Knife installed wrong	Readjust Lower Knife
4	Knives do not trim neatly (1)Knives installed wrong; (2) Dull lower Knife	Correct as follow (1)Readjust Knives; (2)Sharpen or replace new Knives
5	Thread Disc or Guide is burred	Grind off ,polish or replace new one
6	Needle Point is damaged	Replace new Needle
7	Inadequate heigh of Feed Dogs	Readjust Feed Dogs.
8	Inadequate thread tension	Readjust Thread Tension Nut

WRINKLED STITCHES

NO.	REASON	CORRECT
1	Thread tension is too strong	Readjust Thread Tension Nut
2	Inadequate pressure of Presser Foot	Readjust Presser Foot pressure
3	Inadequate height of Feed Dogs	Readjust Feed Dogs
4	Knives do not trim neatly	Readjust Knives or sharpen Knives
5	Differential feed is not matched	Readjust differential feed ratio
6	Needle is too thick	Use Proper Needle for fabric and thread
7	Seam width is too narrow against the chain - off finger of Needle Plan.	Readjust seam width or replace chain off finger.

THERAD CHAIN DOES NOT COME OUT SMOOTHLY

NO.	REASON	CORRECT
1	Presser Foot installed wrong	Reset Presser Foot correctly
2	Inadequate timing of Looper Thread Cam	Readjust Looper thread Cam
3	Double Chain Looper installed wrong	Reset Double Chain Looper correctly
4	Wrong threading	Rethreading correctly
5	Inadequate or too strong thread tension	Readjust Thread Tension Nut
6	Wrong relation of Needle and looper	Readjust Needle and Looper
7	Needle Plate Thread Disc or Presser foot is burred	Grind off, polish or replace new one
8	Thread tension disk is rough	Polish thread tension disk

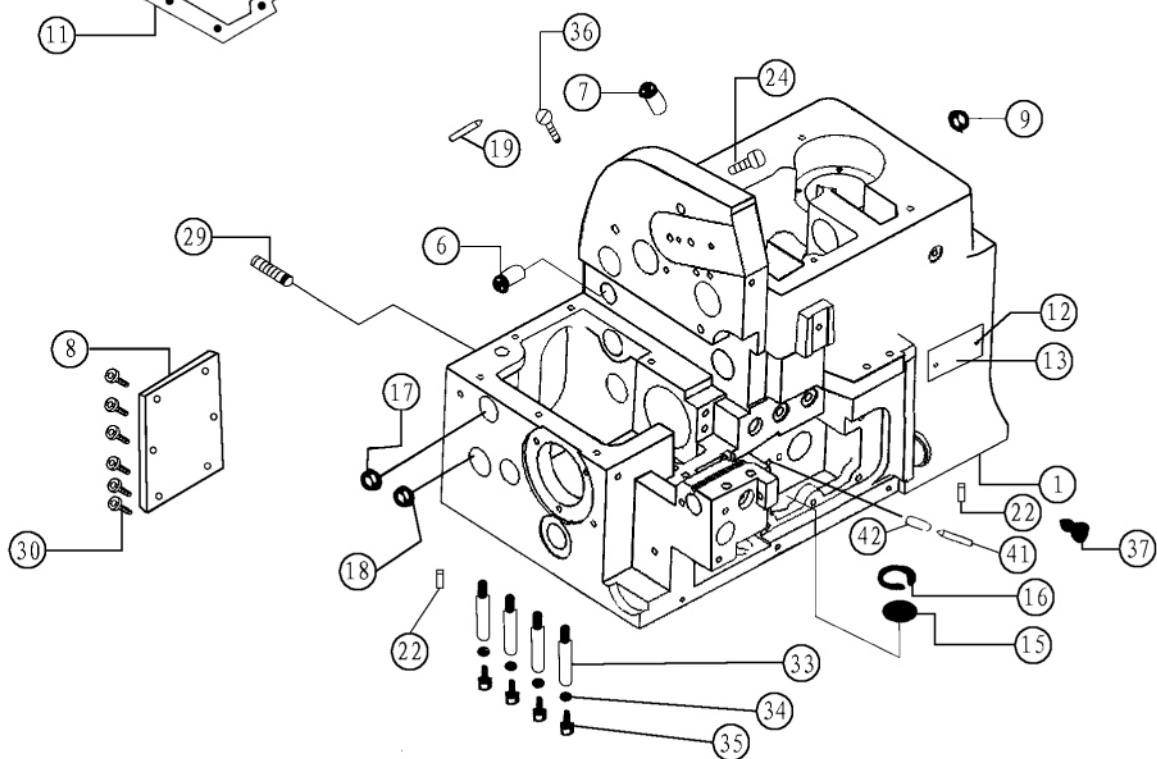
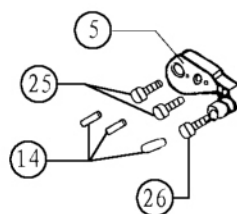
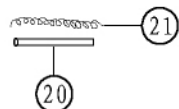
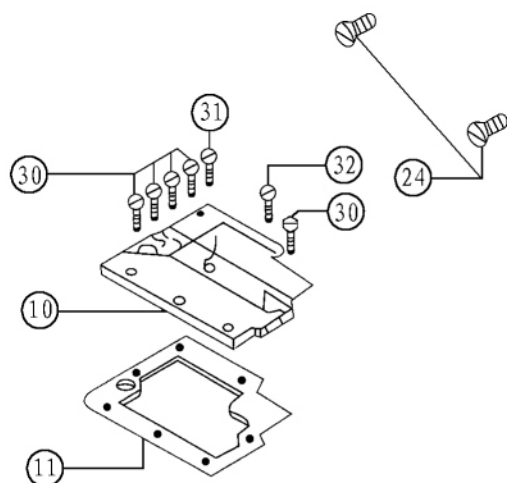
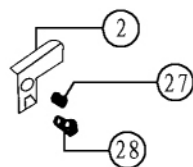
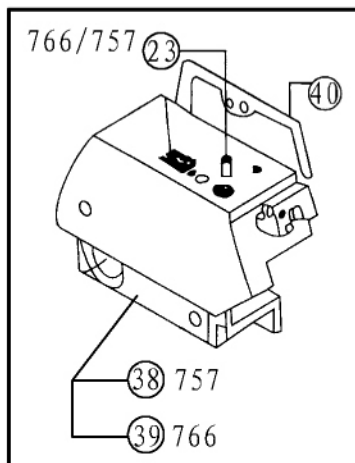

Frame Assembly

NO.	Part NO.	Ref.Part NO.	Description	(Number)		
				Three-thread	Four-thread	Five-thread
1	300031	--- ---	Machine frame	1	1	1
	300741	--- ---	Machine frame	1	1	1
	300811	--- ---	Machine frame	1	1	1
2	20112001	KA04E1	Needle thread cover plate	1	1	1
3	300082	--- ---	Left upper cover	1	1	1
4	20122001	--- ---	Left upper cover pad	1	1	1
5	20101003	KA09	Needle plate	1	1	1
6	20122002	KA14	Rear oil adhesive	1	1	1
7	20122003	KA22	Oil seal	1	1	1
8	20112002	KA25	Rear cover	1	1	1
9	20122005	KA26	Oil cover	1	1	1
10	20101004	KA27	Cover	1	1	1
11	20122007	KA29	Cover washer	1	1	1
12	R03001	KA33	Rivet	2	2	2
13	20137001	--- ---	Machine model plate	1	1	1
14	P01003	KA39	Pin	3	3	3
15	20112003	KA40	Oil screen	1	1	1
16	H01003	KA42	Snap ring	1	1	1
17	20122008	KA21	Oil seal I	2	2	1
18	20122009	KA24	Oil seal II	1	1	1
19	20626004	240190	Oil amount adjusting pin	1	1	1
20	20121019	--- ---	Oil tube	1	1	1
21	20127001	--- ---	Spring	1	1	1
22	20126001	--- ---	Pin	2	2	2
23	20121019	KA12	Oil tube	1	1	1
24	201S11028	SK292	Screw	3	3	3
25	201S11027	SK290	Screw	2	2	2
26	201S11029	SK299	Screw	1	1	1
27	S10005	SK216	Screw M3 × 3	1	1	1
28	201S11033	SK357	Screw	1	1	1
29	201S14002	SK268	Screw	1	1	1
30	201S11016	SK257	Screw	11	11	11
31	201S12005	SK261	Screw	1	1	1
32	201S12006	SK280	Screw	1	1	1
33	201S30006	SK401	Screw	4	4	4
34	20128023	WK23	Washer	4	4	4
35	201S13002	SK400	Screw	4	4	4
36	201S11021	SK272	Screw	1	1	1
37	201S11039	SK308	Screw	1	1	1
38	300070	KA04F	Front oncde cover	1	1	1
39	300080	KA04F	Front oncde cover	1	1	1
40	20222001	KA06F	Front oncde cover pad	1	1	1
41	P01003	--- ---	Pin	1	1	1
42	20523003	--- ---	Oil wick	1	1	1

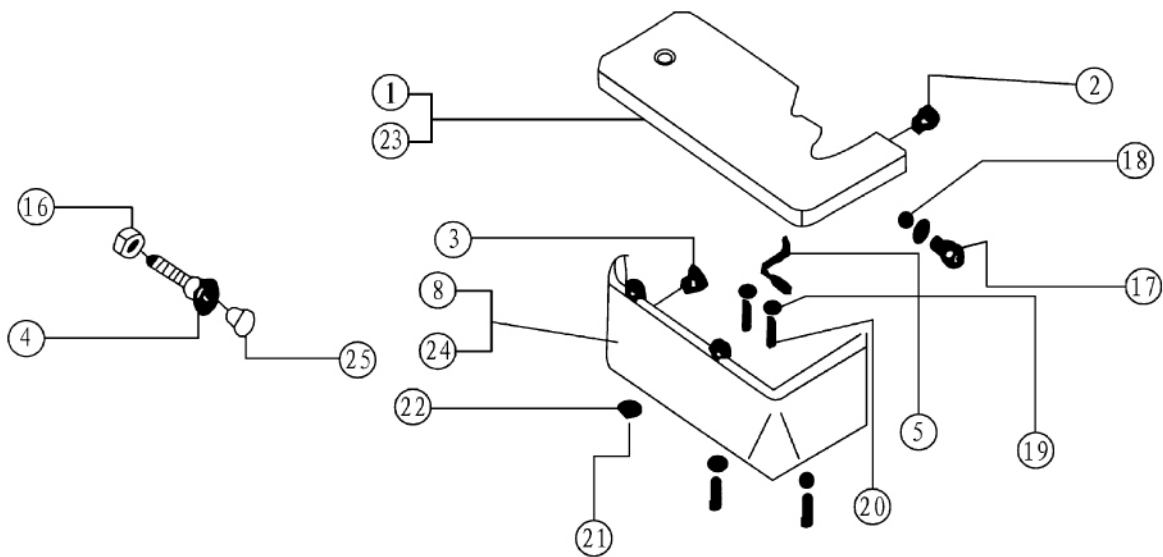
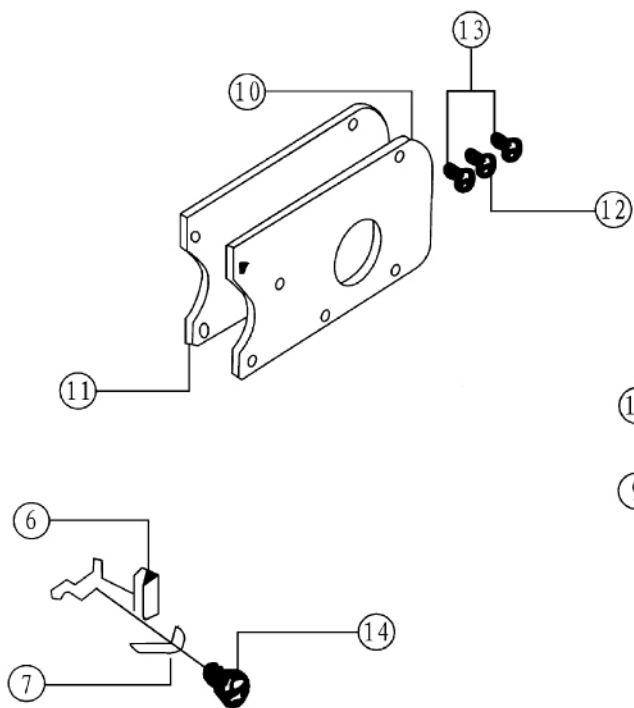

Cloth Plate Assemblies

NO.	Part NO.	Ref.Part NO.	Description	(Number)		
				Three-thread	Four-thread	Five-thread
1	2011200400	KB01E	Cloth plate	1	1	0
2	20122012	KB05	Rubber bushing	1	1	1
3	20122013	KB05E	Rubber bushing	1	1	1
4	201S30011	KB06E-1	Screw	1	1	1
5	20127003	KB12B	Spring	1	1	1
6	20112011	KB15B	Cloth plate slider cover	1	1	1
7	20127004	KB17	Cloth plate cover spring	1	1	1
8	20111001	KB22F	Cloth plate lower plate	1	1	0
9	20111003	KB29	Washer	1	1	1
10	20112012	KB31D-1	Upper looper sealing plate	1	1	1
11	20122015	KB31D-2	Upper looper sealing plate washer	1	1	1
12	201S11018	SK262	Screw	1	1	1
13	201S11016	SK257	Screw	2	2	2
14	201S20003	SK279	Screw	1	1	1
15	201S17004	SK217	Screw	2	2	2
16	201S16003	NK26	Nut	1	1	1
17	201S30007	SK403	Screw	1	1	1
18	201S16001	NK23	Nut	1	1	1
19	W01005	WK06	Washer 3	2	2	2
20	201S11005	SK221	Screw	2	2	2
21	201S11037	SK560	Screw	3	3	3
22	20128019	WK05	Washer	3	3	3
23	2011200500	KB02E	Cloth plate	0	0	1
24	20111002	KB23F	Cloth plate lower plate	0	0	1
25	20122011	KB03	Rubber bushing	1	1	1

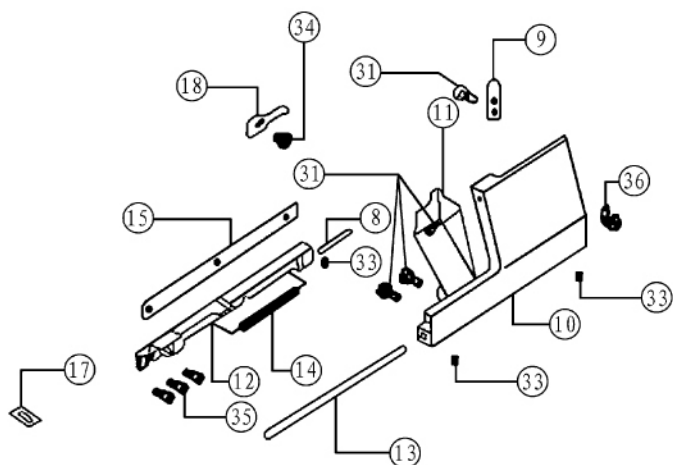
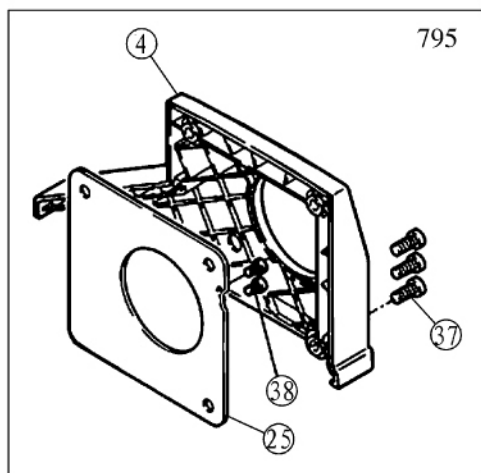
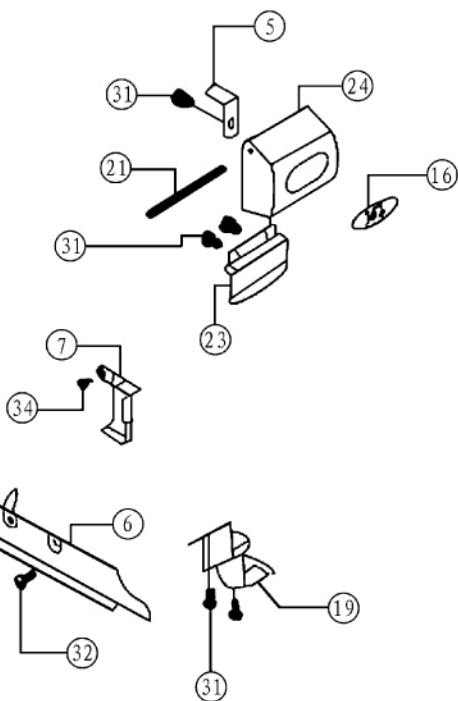
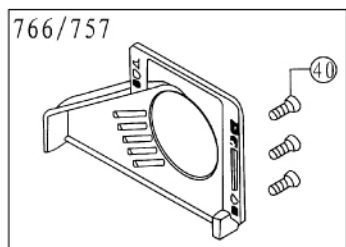
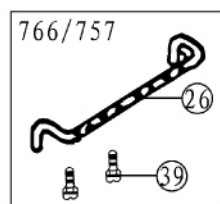
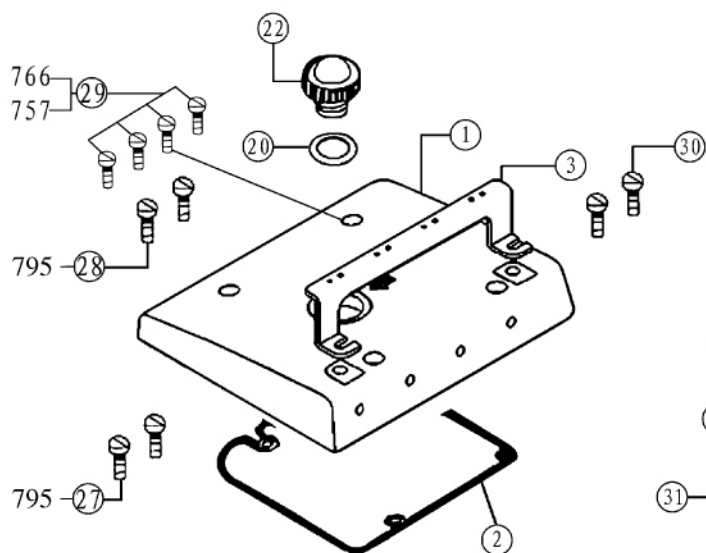

Cover Assemblies

NO.	Part NO.	Ref.Part NO.	Description	(Number)		
				Three-thread	Four-thread	Five-thread
1	300083	--- ---	Upper cover	1	1	1
	300072	KC01F	Upper cover	1	1	1
	300475	--- ---	Upper cover	1	1	1
	300081	--- ---	Upper cover	1	1	1
2	20122016	--- ---	Upper cover washer	1	1	1
	20322003	KC03	Upper cover washer	1	1	1
3	20112013	--- ---	Thread guide supporter	1	1	1
	20113030	--- ---	Thread guide supporter	1	1	1
4	20611003	209550-PB	Belt cover	1	1	1
	20211001	KC09F	Belt cover	1	1	1
	20311001	--- ---	Belt cover	1	1	1
5	20112014	KC13	Thread cover spring	1	1	1
6	20112015	KC15	Cloth guide plate	1	1	1
7	20112016	KC17	Oil guide II	1	1	1
8	20126003	KC18	Pin	1	1	1
9	20112017	KC20	Front spring	1	1	1
10	300073	KC21E	Front cover	1	1	1
11	20112018	KC22B	Front cover guard	1	1	0
	20112019	KC23B	Front cover guard	0	0	1
12	20101007	KC24B	Front cover hinge	1	1	1
13	20126004	KC25B	Hinge pin	1	1	1
14	20127005	KC28	Front cover hinge spring	1	1	1
15	20122017	KC29	Front cover hinge washer	1	1	1
16	20137002	--- ---	Trade mark plate	1	1	1
17	20131064	KC39-4	Oil flow sindow	2	2	2
18	20112020	KC36	Front cover snap guard	1	1	1
19	20112021	KC55B	Oil guard	1	1	1
20	20122018	KC58	Oil level gauge washer	1	1	1
21	20126005	KC62	Pin	1	1	1
22	20111005	--- ---	Oil level gauge plate	1	1	1
	20211002	KF67	Oil level gauge plate	1	1	1
23	20111006	--- ---	Oil sight	1	1	1
	20211003	KC69F	Oil sight	1	1	1
24	20111018	--- ---	Upper cover	1	1	1
25	20612005	209551	Right frame plate	1	1	1
26	20313001	KC05E	Thread guide supporter	1	1	1
27	201S11015	SK256	Screw	2	2	2
28	201S11025	SK278	Screw	2	2	2
29	201S11036	SK503	Screw	4	4	4
30	206S11005	4009	Screw	2	2	2
31	201S11009	SK233	Screw	9	9	9
32	201S11018	SK262	Screw	2	2	2
33	201S15001	SK235	Screw	3	3	3
34	201S11014	SK250	Screw	2	2	2
35	201S11038	SK576	Screw	3	3	3
36	H05002	FK03	Snap spring	1	1	1
37	S01013	7176	Screw	3	3	3
38	S01010	7019	Screw	2	2	2
39	S01010	7019	Screw	2	2	2
40	201S11024	SK257	Screw	3	3	3

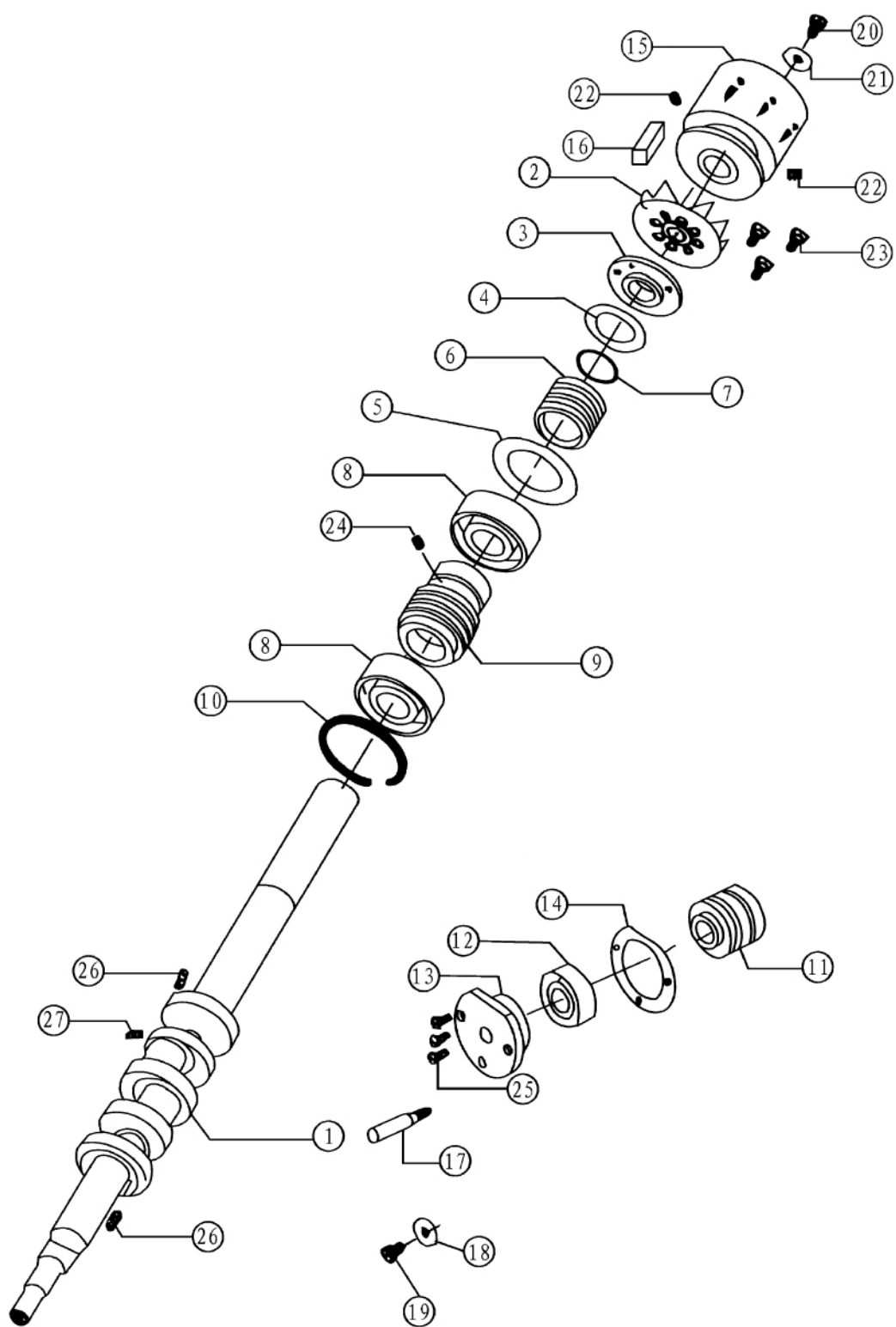

Main Shaft Assemblies

NO.	Part NO.	Ref.Part NO.	Description	(Number)		
				Three-thread	Four-thread	Five-thread
1	20102001	KD01	Main shaft	1	1	1
2	20111008	KD09	wheel	1	1	1
3	20101008	KD10D	Rear shaft bearing cover	1	1	1
4	20122019	KD12D	Washer	1	1	1
5	20128002	KD13	Main shaft spring washer	1	1	1
6	20103002	KD14	Main shaft bysgubg asm	1	1	1
7	O01003	KD15	Seal ring	1	1	1
8	B03001	KD16	Bearing	2	2	2
9	20125001	KD17	Oil pump worm	1	1	1
10	20129001	KD20	Snap spring	1	1	1
11	20103003	KD21	Main shaft left bushing	1	1	1
12	B04001	KD22	Bearing	1	1	1
13	20101009	KD27D	Bearing cover	1	1	0
	20101010	KD26D	Bearing cover	0	0	1
14	20122020	KD28D	Bearing cover washer	1	1	1
15	20101044	--- ---	Pulley	1	1	1
16	20101012	--- ---	Key	1	1	1
17	20126006	KD33	Bulgy pulley shaft	0	0	1
18	30128008	240102	washer	1	1	0
19	201S11040	777-5361	Screw	1	1	0
20	201S11034	SK374	Screw	1	1	1
21	20128024	WK24	washer	1	1	1
22	201S15004	SK347	Screw	2	2	2
23	201S11016	SK257	Screw	3	3	3
24	201S14002	SK270	Screw	1	1	1
25	201S11012	SK241	Screw	3	3	3
26	201S15005	SK396	Screw	2	2	2
27	201S15001	SK235	Screw	1	1	1

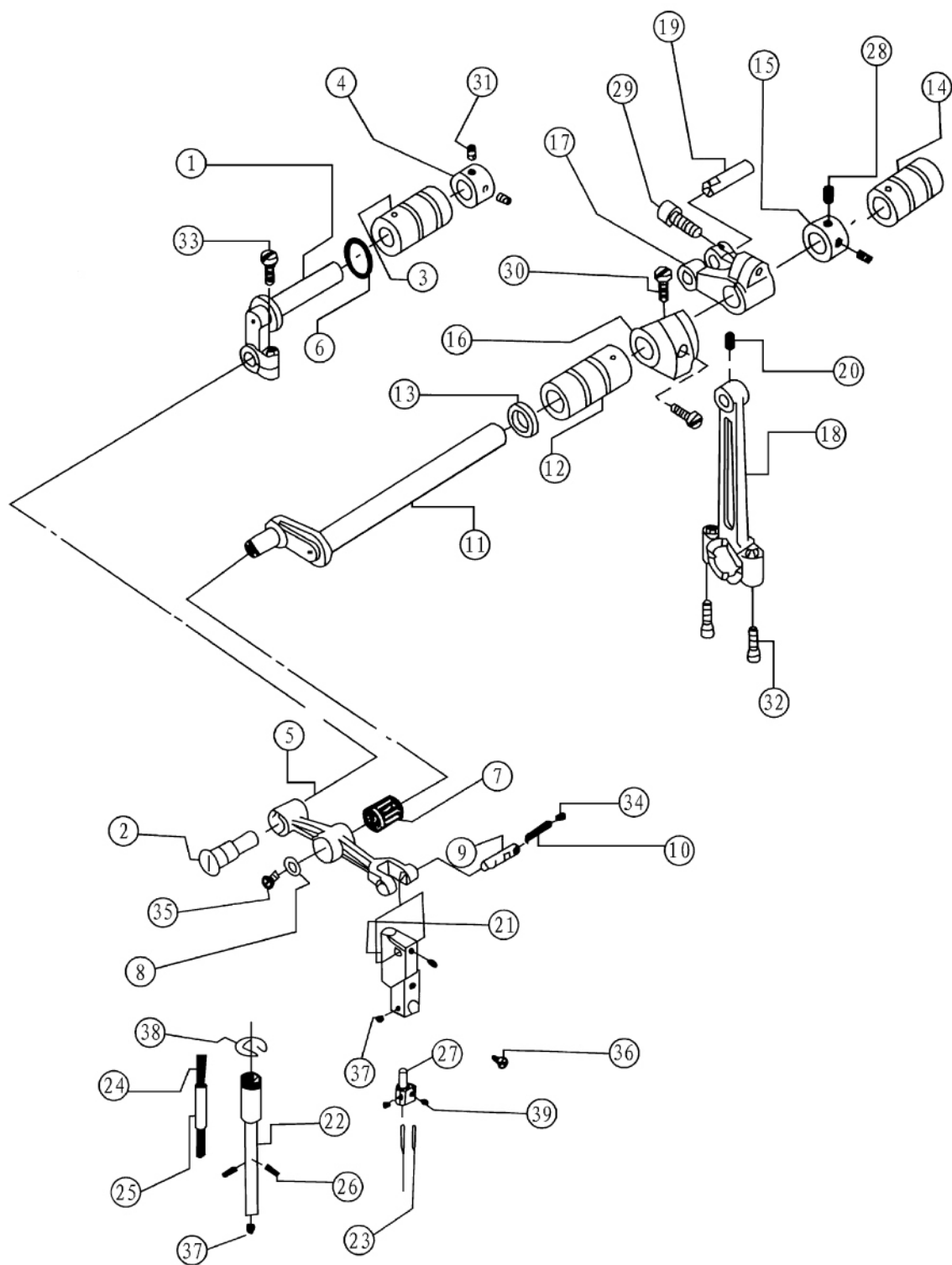

Needle Bar Assemblies

NO.	Part NO.	Ref.Part NO.	Description	(Number)		
				Three-thread	Four-thread	Five-thread
1	20102002	KFO1F	Needle bar driving frame rock shaft	1	1	1
2	20126007	KFO2	Eccentric shaft	1	1	1
3	20103004	KFO5	Needle bar shaft bushing back	1	1	1
4	20108001	KFO7	Snap ring	1	1	1
5	20104001	KFO9	Throat driving crank	1	1	1
6	20122022	KF38	Oil seal	1	1	1
7	B07006	KF11	Needle bearing	1	1	1
8	20128004	KF12	Washer ring	1	1	1
9	20126008	KF14	Throat clip guide ping	1	1	1
10	20123021	KF16	Oil wick	1	1	1
11	20102003	KF17	Throat bar rock crank	1	1	1
12	20103005	KF18	Needle driving shaft bearing	1	1	1
13	20122021	KF19	Seal ring	2	2	2
14	20103006	KF20	Needle driving shaft bearing	1	1	1
15	20108002	KF21	Snap ring	2	2	2
16	20101013	KF23	Balance block	1	1	1
17	20104002	KF26	Needle bar frame rock shaft crank	0	1	0
	20104003	KF25	Needle bar frame rock shaft crank	1	0	1
18	20105001	KF28	Needle bar connecting rod	1	1	1
19	20126009	KF30	Connecting link pin	1	1	1
20	201S12005	SK261	Screw	1	1	1
21	20101014	KF32	Throat clip guide bushing	1	1	1
22	2010200400	--- ---	Needle bar	1	1	1
23	20117012	DC × 27	Needle	1	2	0
	20117013	DC × 27	Needle	0	0	2
	20117014	DC × 27	Needle	0	0	2
24	20123021	KF35	Oil wick	1	1	1
25	20121020	KF35-1	Plastic tube	1	1	1
26	20123005	KF37	Oil wick	2	2	2
27	20134002	KG142-E	Needle clamp	1	0	0
	20134001	KG131-E	Needle clamp	0	1	0
	20134003	KG153-E	Needle clamp	0	0	1
	20134004	KG155-E	Needle clamp (for thick)	0	0	1
28	201S15003	SK293	Snap ring screw	2	2	2
29	201S13003	SK612	Hexagon socket screw	1	1	1
30	201S30003	SK291	Balance block position screw	2	2	2
31	201S14002	SK293	Frame rock shaft set screw	3	3	3
32	201S20006	SK385	Shaft position screw	2	2	2
33	201S11026	SK287	Screw	1	1	1
34	201S17001	SK204	Screw	1	1	1
35	201S17004	SK217	Screw	1	1	1
36	S01022	SK221	Screw	1	1	1
37	S010005	SK216	Screw	4	4	4
38	H05008	EK01	Snap ring	1	1	1
39	201S14001	SK216	Screw	2	2	

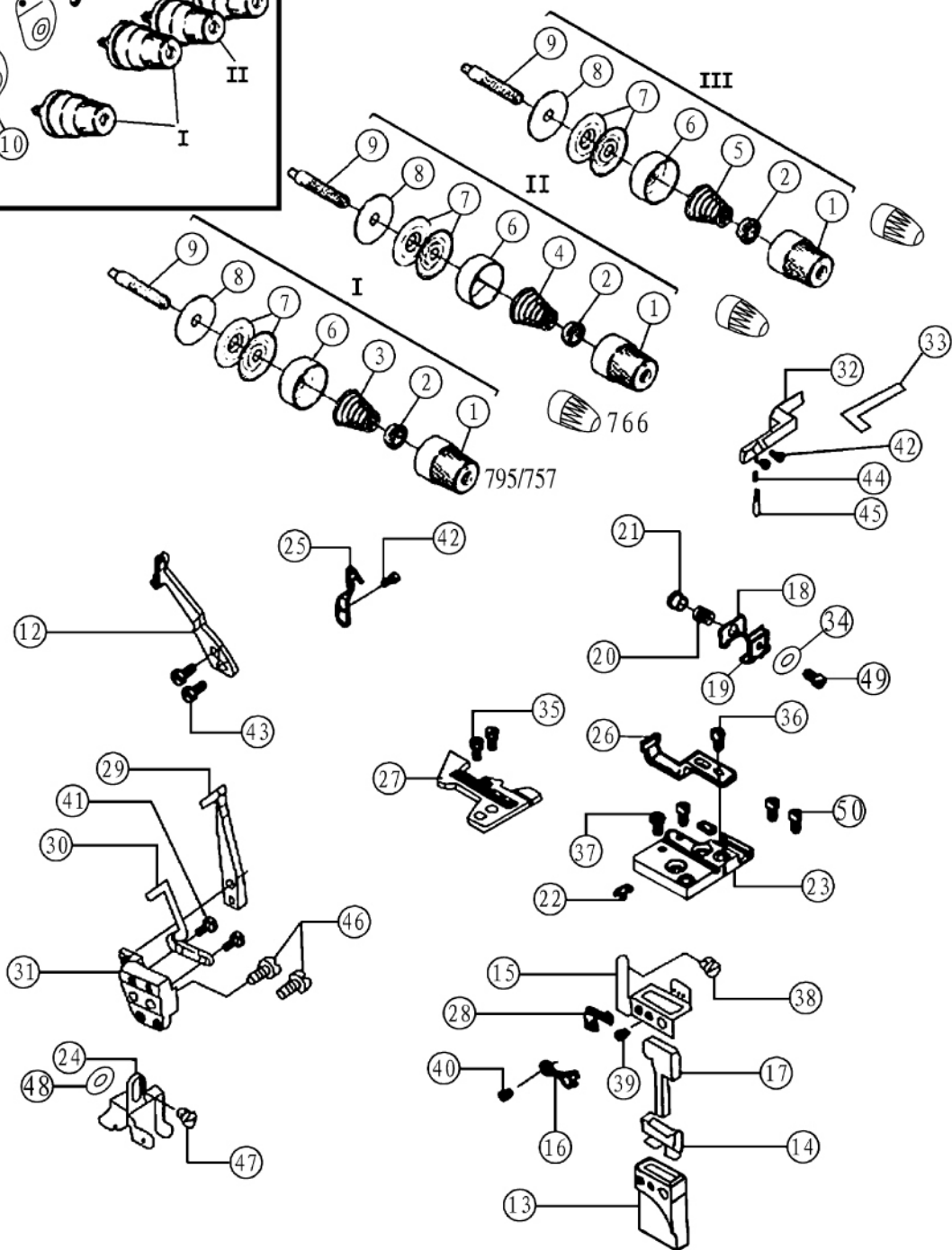
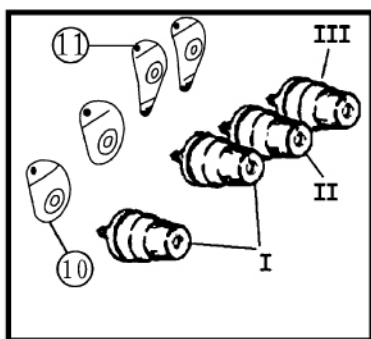

Thread Guide Assemblies

NO.	Part NO.	Ref.Part NO.	Description	(Number)		
				Three-thread	Four-thread	Five-thread
1	20111013	208447-UA	Thread tension screw	3	4	4
	20311002	KG04F	Thread tension screw	3	4	4
2	20111014	208448	Thread tension spring	3	4	4
3	20127018	201037	Thread tension spring	1	2	2
4	20127019	201068	Thread tension spring	1	1	1
5	20127020	201086	Thread tension spring	1	1	1
6	20111015	208450-UA	Thread tension spring	3	4	4
7	20112057	210319	Thread tension disc	6	8	8
8	20123018	208449	Thread tension disc washer	3	4	4
9	201S30016	005082A	Thread tension screw	3	4	4
10	20113001	209622	Thread guide	1	2	2
	20213001	209622	Thread guide	1	2	2
11	20113002	202849	Thread guide	2	2	2
	20213002	202849	Thread guide	2	2	2
12	20113003	KG11F	Upper thread take-up	1	1	0
	20113004	KG6F	Upper thread take-up	0	0	1
13	20111009	KG12	Oil box	1	1	1
14	20112022	KG13	Oil felt	1	1	1
15	20113005	KG14	Thread guide	1	1	1
16	20122023	KG15D	Oil box washer	1	1	1
17	20123006	KG16	Oil felt	1	1	1
18	20113006	KG17	Tension spring	1	1	1
19	20113007	KG18	Thread controller disc holder	1	1	1
20	20127006	KG19	Spring	1	1	1
21	20103008	KG21	Thread controller disc guide bushing	1	1	1
22	20101015	KG24-1	Throat plate positioning rod	2	2	2
23	20101016	KG24-2D	Throat plate bracket	1	1	1
24	20113008	KG54	Thread mark guide	1	1	0
	20113009	KG42	Thread mark guide	0	0	1
25	20117002	KG59	Teat needle guard	1	1	1
26	20117003	KG471	Front needle guard	1	0	0
	20117004	KG472	Front needle guard	0	1	0
27	20115001	E800	Needle plate	1	0	0
	20115002	E919	Needle plate	0	1	0
	20115003	E982	Needle plate	0	0	1
	20115004	--- ---	Needle plate	1	0	0
	20115005	--- ---	Needle plate	0	1	0
	20115006	--- ---	Needle plate	1	0	0
	20115007	--- ---	Needle plate	0	0	1
	20115008	--- ---	Needle plate	0	0	1
	20115009	--- ---	Needle plate	1	0	0
28	20113010	KG25	Thread guide	0	0	1
29	20117005	KG31D	Needle guard I	0	0	1
30	20117006	KG37	Needle guard II	0	0	1
31	20101017	KU18	Needle guard bracket	1	1	0
	20101018	KG39	Needle guard bracket	0	0	1
32	20101019	KG26-E	Snap plate	1	1	1
33	20122024	KG46	Snap plate washer	1	1	1
34	W01011	KF31	Washer	1	1	1
35	201S17005	SK260	Throat screw	2	2	2
36	201S11008	SK230	Front needle snap screw	1	1	1
37	201S11029	SK299	Throat plate bracket screw	2	2	2
38	201S11014	SK250	Thread guide holder screw	1	1	1
39	201S11001	SK207	Oil box set screw	1	1	1
40	201S20005	SK359	Oil box set screw	1	1	1
41	201S11003	SK209	Rear needle guard screw	2	2	2
42	201S12009	SK242	Needle guard screw	3	3	3
43	201S11009	SK233	Thread take up screw	2	2	2
44	201S15001	SK235	Snap plate screw II	1	1	1
45	201S30010	SK236	Snap plate set screw	1	1	1
46	201S11022	SK275	screw	2	2	2
47	201S11018	SK262	screw	1	1	1
48	20128030	KQ42	Washer	1	1	1
49	S01006	SK221	screw	1	1	1
50	20122011	KB05	Rubber bushing	2	2	2

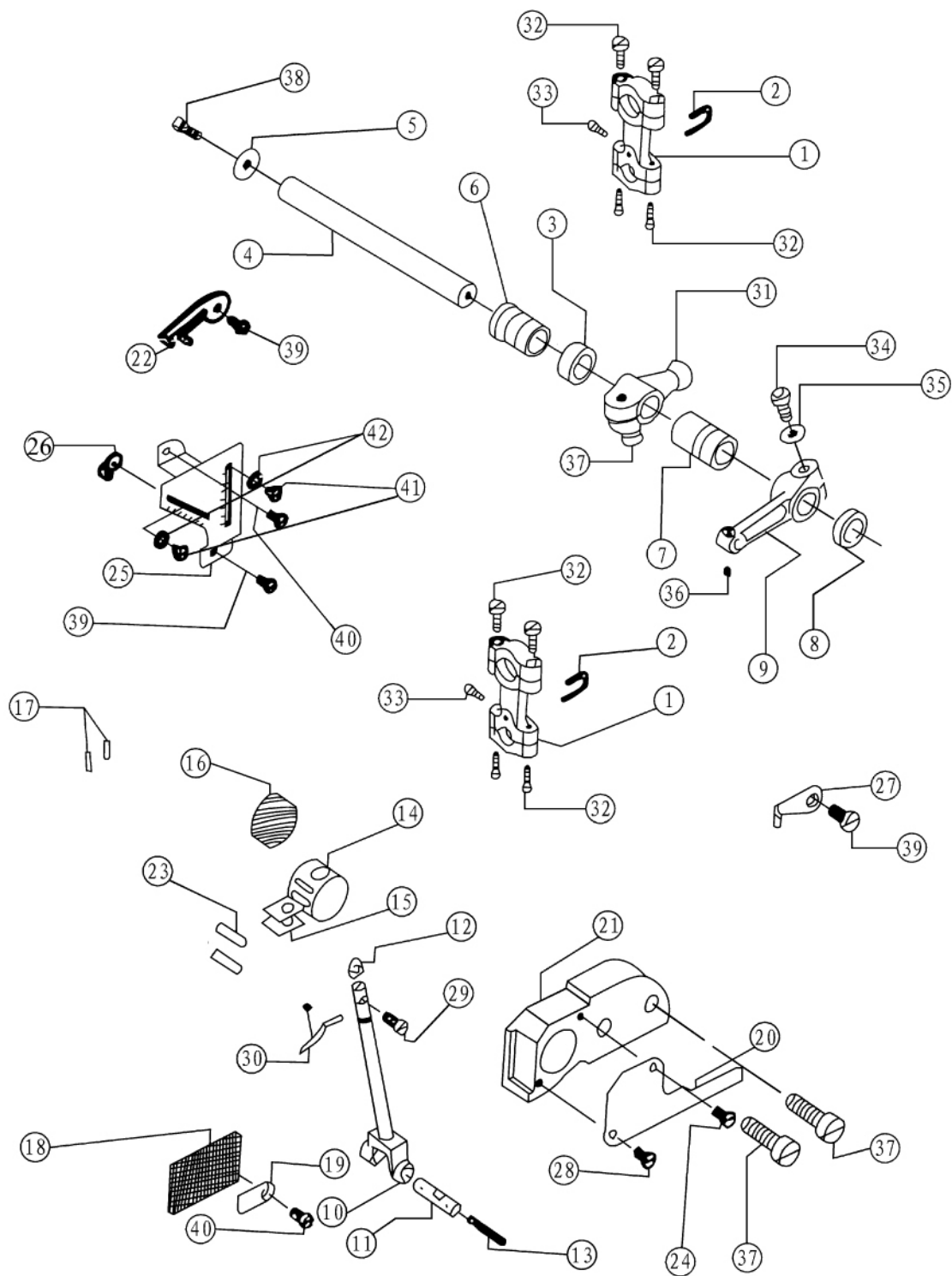

Upper Looper Assemblies

NO.	Part NO.	Ref.Part NO.	Description	(Number)		
				Three-thread	Four-thread	Five-thread
1	20105002	KJ01B	Looper link	2	2	2
2	20126010	KJ06B	Looper link holder	2	2	2
3	20128005	KJ13F	Thickness washer	1	1	1
4	20102006	KJ15	Upper looper shaft	1	1	1
5	20128007	KJ16	Big washer	1	1	1
6	20103009	KJ19F	Upper looper shaft rear bushing	1	1	1
7	20103010	KJ20	Upper looper shaft front bushing	1	1	1
8	20122025	KJ21	Upper looper shaft oil seal	1	1	1
9	20104004	KJ22	Upper looper shaft crank	1	1	1
10	20104005	KJ26	Upper looper shaft bar	1	1	1
11	20126011	KJ27	Connecting rod shaft pin	1	1	1
12	20112023	KJ28	Washer	1	1	1
13	20123021	KJ29	Oil wick	1	1	1
14	20109001	KJ30F	Upper looper slide block	1	1	1
15	20123008	KJ33	Oil felt	2	2	2
16	20123009	KJ34	Oil felt	1	1	1
17	20113013	KJ58	Thread tube	2	2	2
18	20112024	KJ39F	Screen oil plate	1	1	1
19	20112025	KJ40F	Felt plate	1	1	1
20	20112026	KJ41	Thread holder snap plate	1	1	1
21	20101020	KJ42E	Upper looper shaft slide bar bracket	1	1	1
22	20113014	KJ68	Tow for thread guide	1	1	1
23	20523003	KJ44	Oil wick	1	1	1
24	201S11005	SK221	Screw	1	1	1
25	20112027	KJ61D	Thread amount regulating plate	1	1	1
26	20113011	KJ63	Upper looper thread guard	1	1	1
27	20113012	KJ66D	Upper looper shaft thread plate	1	1	1
28	201S17006	SK451	Screw	1	1	1
29	201S11007	SK229	Upper looper set screw	1	1	1
30	20117007	LP26	Looper	1	1	1
31	20104006	KJ11B-E	Upper looper crank bearing	0	1	1
	20104007	KG09B-E	Upper looper crank bearing	1	0	0
32	201S20006	SK385	Shaft screw	8	8	8
33	201S11035	SK408	Screw	2	2	2
34	201S12007	SK298	Upper looper crank screw	1	1	1
35	20128021	WK11	Washer	1	1	1
36	S10005	SK216	Link pin set screw	1	1	1
37	201S13003	S102	Nexagon socket screw	3	3	3
38	201S12005	SK261	Upper looper shaft screw	1	1	1
39	201S11016	SK257	Thread guide screw	3	3	3
40	201S11014	SK262	Screw	2	2	2
41	201S11006	SK223	Thread guide screw	2	2	2
42	20128020	WK09	Thread guide washer	2	2	2

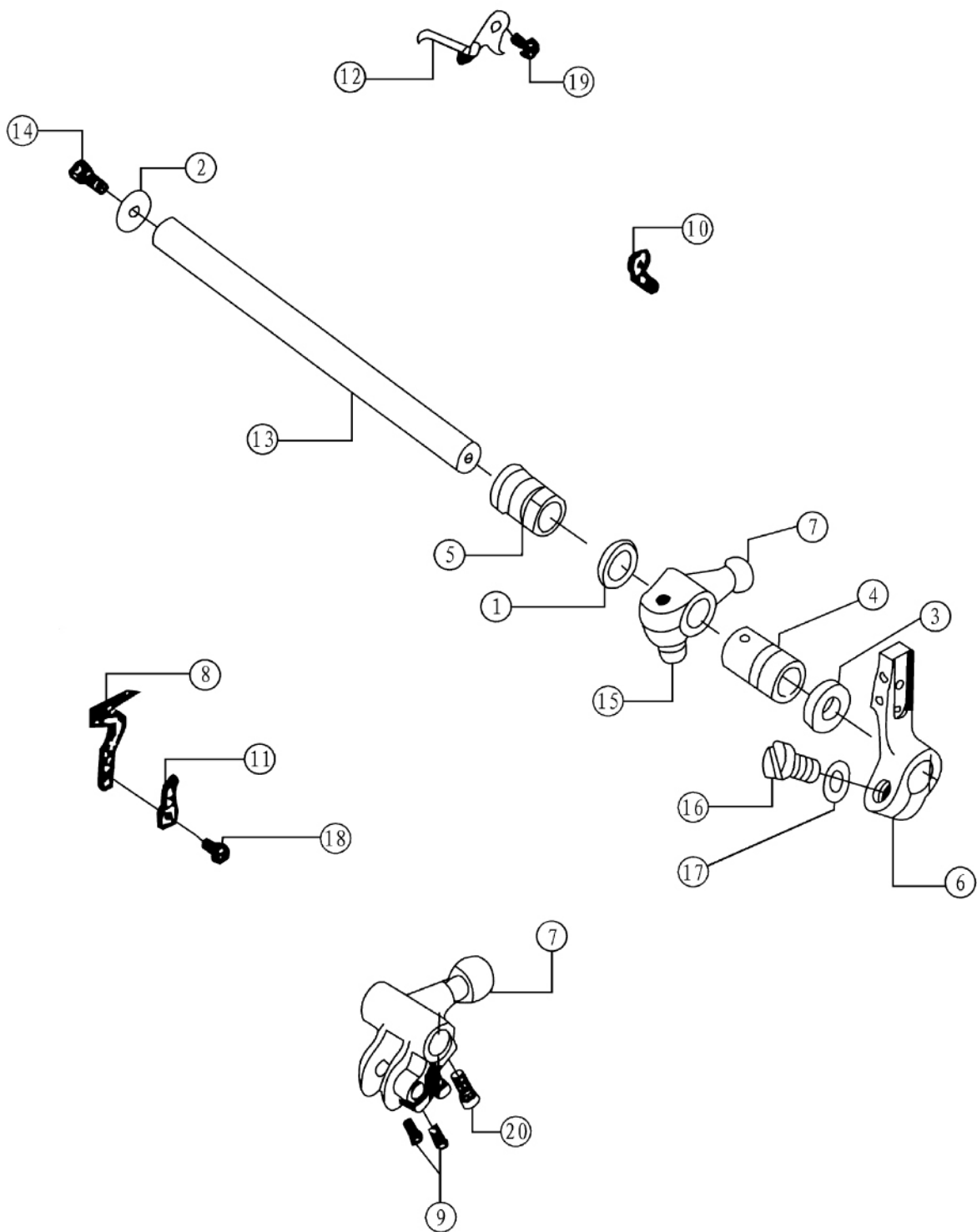

Lower Looper Assemblies

NO.	Part NO.	Ref.Part NO.	Description	(Number)		
				Three-thread	Four-thread	Five-thread
1	20128009	KJ13F	Washer	1	1	1
2	20128007	KJ16	Lower looper shaft washer	1	1	1
3	20622019	KL20	Oil seal	1	1	1
4	20103011	KL21	Lower looper front bushing	1	1	1
5	20103015	KN11	Left horizontal shaft bushing	1	1	1
6	20104008	KL23-3	Lower looper holder	1	1	0
	20104025	--- ---	Lower looper holder	0	0	1
7	20104009	KL612	Lower looper crank	1	1	0
	20104010	KL09B	Lower looper crank	0	0	1
8	20117008	KL25	Lower looper	1	1	0
	20117009	--- ---	Lower looper	0	0	1
9	201S11007	SK230	Crank screw	0	0	2
10	20113015	KL38	Thread guide	1	1	1
11	20113016	KL43	Lower looper thread guide	1	1	1
12	20113017	KL46	Lower looper3-thread guide	1	1	1
13	20102007	KL57	Lower looper shaft	1	1	0
	20102008	KL16	Lower looper shaft	0	0	1
14	201S12005	SK261	Low looper shaft screw	1	1	1
15	201S13003	SK612	Crank screw	1	1	1
16	201S12007	SK298	Lower looper holder screw	1	1	1
17	20128021	WK11	Lower looper holder washer	2	2	2
18	206S11002	SK241	Lower looper	1	1	1
19	201S11016	SK257	Thread guide screw	1	1	1
20	301S30013	200152	Crank screw	0	0	

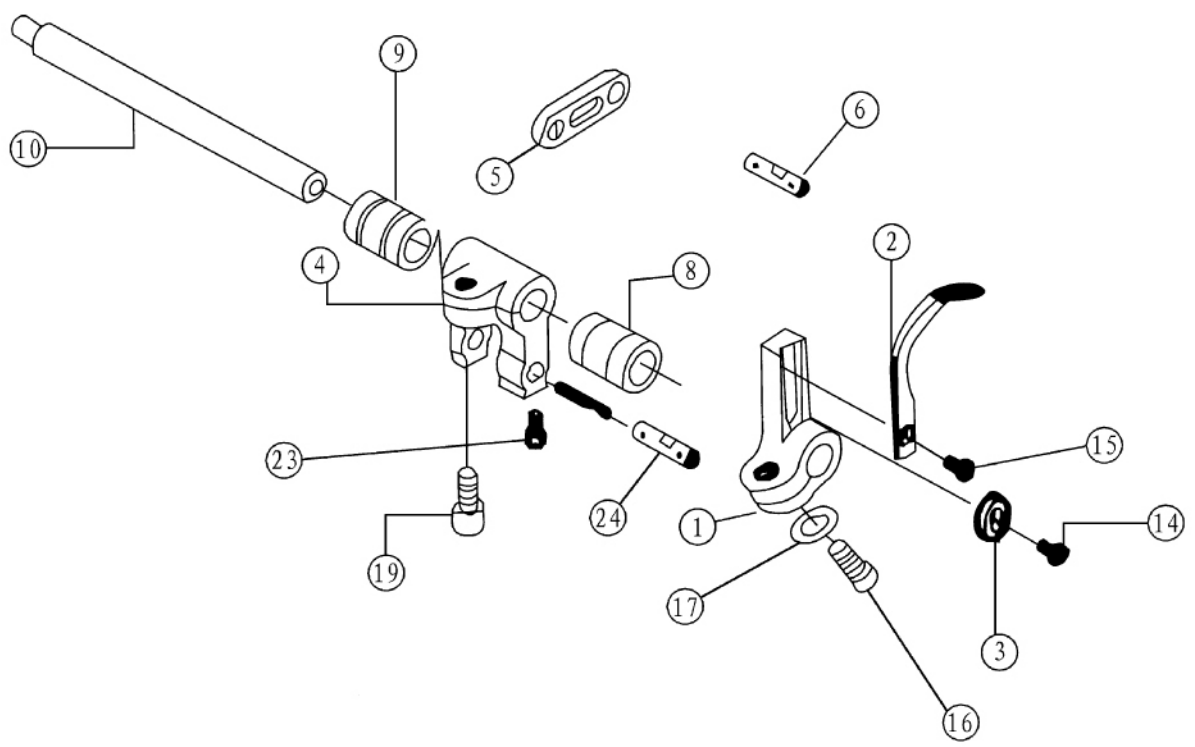
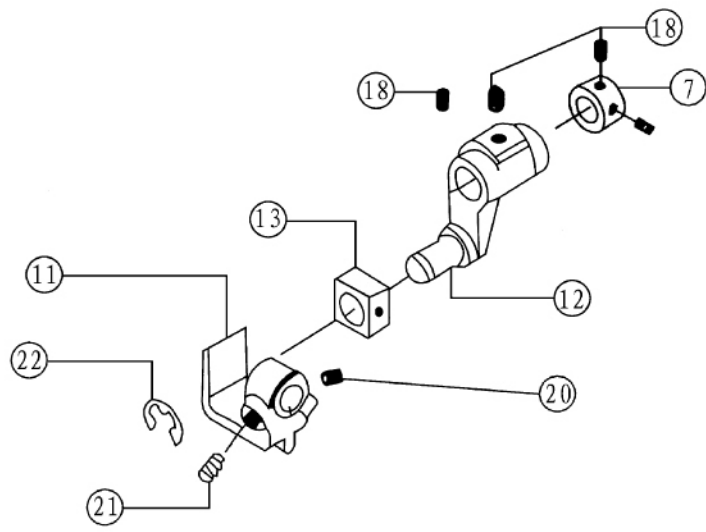

Front Loper Assemblies

NO.	Part NO.	Ref.Part NO.	Description	(Number)		
				Three-thread	Four-thread	Five-thread
1	20104011	KM01	Front looper shaft holder	0	0	1
2	20117010	KM04	Front looper	0	0	1
3	20128014	KM06	Washer	0	0	1
4	20104012	KM08	Front looper crank	0	0	1
5	20609017	KM11	Regulating plate	0	0	1
6	20126013	KM12	Regulating plate pin	0	0	2
7	20108001	KF07	Snap ring	0	0	1
8	20103013	KM17	Front looper shaft front bushing	0	0	1
9	20103014	KM18	Front looper shaft rear bushing	0	0	1
10	20102009	KM26	Front looper shaft	0	0	1
11	20101021	KM27D	Driving lever	0	0	1
12	20104013	KM28	Driving crank	0	0	1
13	20109002	KM29D	Front looper slide block	0	0	1
14	201S11003	SK209	Thread guide screw	0	0	1
15	201S11008	SK230	Front looper guide set screw	0	0	1
16	201S12007	SK298	Front looper holder set screw	0	0	1
17	20128021	WK11	Washer	0	0	1
18	201S12002	SK251	Front looper crank screw	0	0	4
19	201S13003	SK612	Crank holder set screw	0	0	1
20	201S14002	SK270	Driving lever set screw	0	0	1
21	201S30009	SK499	Driving lever set screw	0	0	1
22	20129003	EK03	Snap ring	0	0	1
23	201S12005	SK261	Screw	0	0	1
24	20126022	--- ---	Regulating plate pin	0	0	1

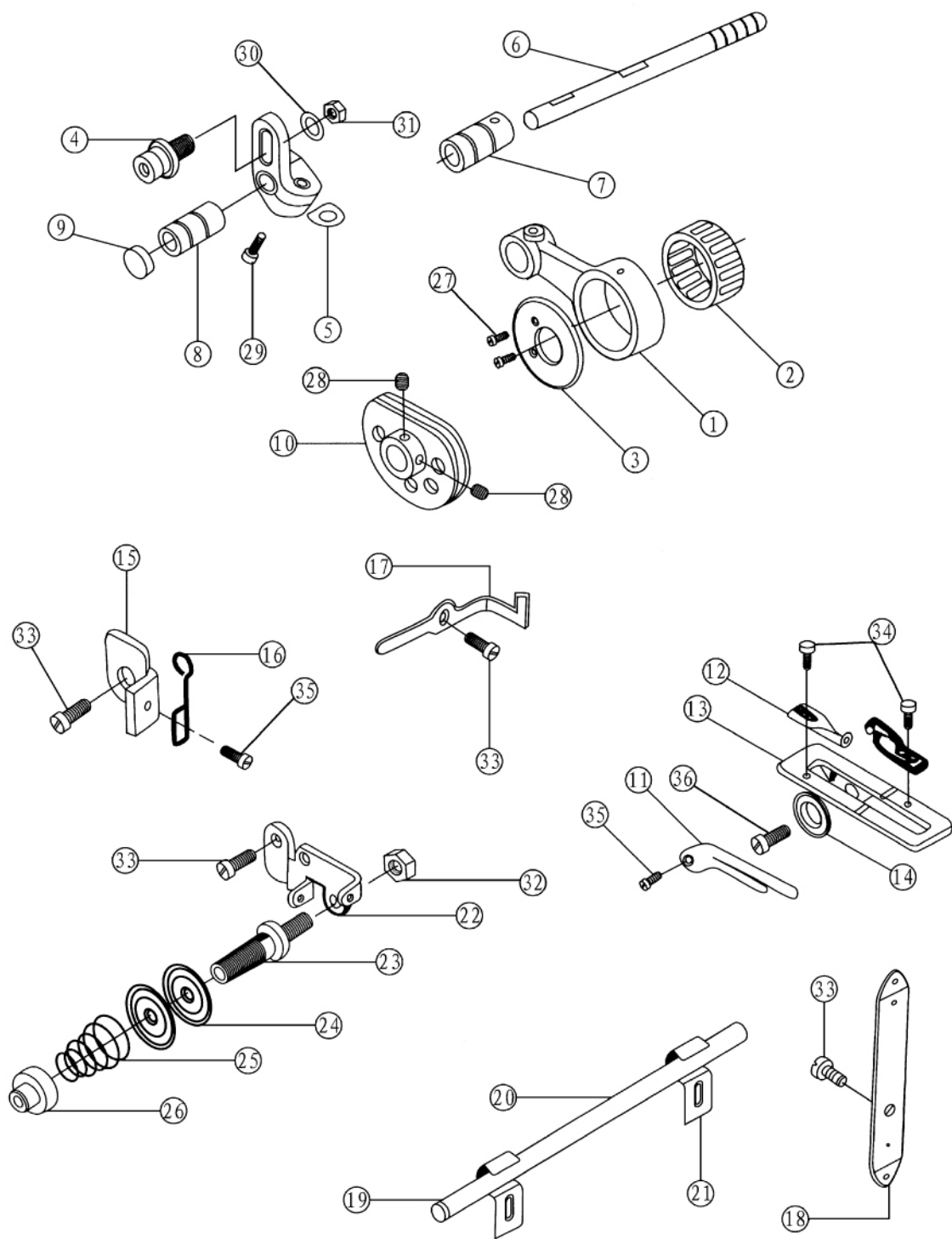

Cam Assemblies

NO.	Part NO.	Ref.Part NO.	Description	(Number)		
				Three-thread	Four-thread	Five-thread
1	20105003	KN01	Horizontal shaft link	0	0	1
2	20124002	KN02	Needle bearing	0	0	1
3	20112028	KN03	Snap ring	0	0	1
4	20126014	KN05	Pin	0	0	1
5	20104014	KN08	Horizontal shaft crank	0	0	1
6	20102010	KN10	Horizontal shaft	0	0	1
7	20103015	KN11	Left horizontal shaft bushing	0	0	1
8	20103016	KN12	Right horizontal shaft bushing	0	0	1
9	20122028	KN13	Oil seal	0	0	1
10	2011301800	KM8	Looper thread take-up cam	0	0	1
11	20113020	KN20	Thread guide	0	0	1
12	20113021	KN22	Thread	0	0	2
13	20112029	KN24	Bracket	0	0	1
14	20128015	KN26	Flat spring	0	0	1
15	20112030	KN27	Astrict position plate	0	0	1
16	20113022	KN29	Thread guide ring	0	0	1
17	20113023	KN32	Thread guide	0	0	1
18	20113024	KN34	Thread guide	0	0	1
19	20113025	KN36-1	Thread pipe cover	0	0	2
20	20113026	KN36-2	Thread pipe	0	0	1
21	20112031	KN37	Bracket	0	0	2
22	20112032	KN38	Bracket	0	0	1
23	201S30012	KN40	Screw	0	0	1
24	20112033	KN42	Tension disc	0	0	2
25	20127007	KN43	Spring	0	0	1
26	201S16007	KN44	Nut	0	0	1
27	201S17001	SK205	Bearing snap ring screw	0	0	2
28	201S14001	SK216	Cam set screw	0	0	2
29	201S13003	SK612	Crank set screw	0	0	1
30	20128033	WK11	Washer	0	0	1
31	201S16002	WK04	Nut	0	0	1
32	201S16003	NK26	Nut	0	0	1
33	201S11014	SK257	Screw	0	0	4
34	201S11001	SK207	Thread guide plate screw	0	0	2
35	201S11009	SK233	Thread guide plate screw	0	0	2
36	201S20001	SK264	Screw	0	0	1

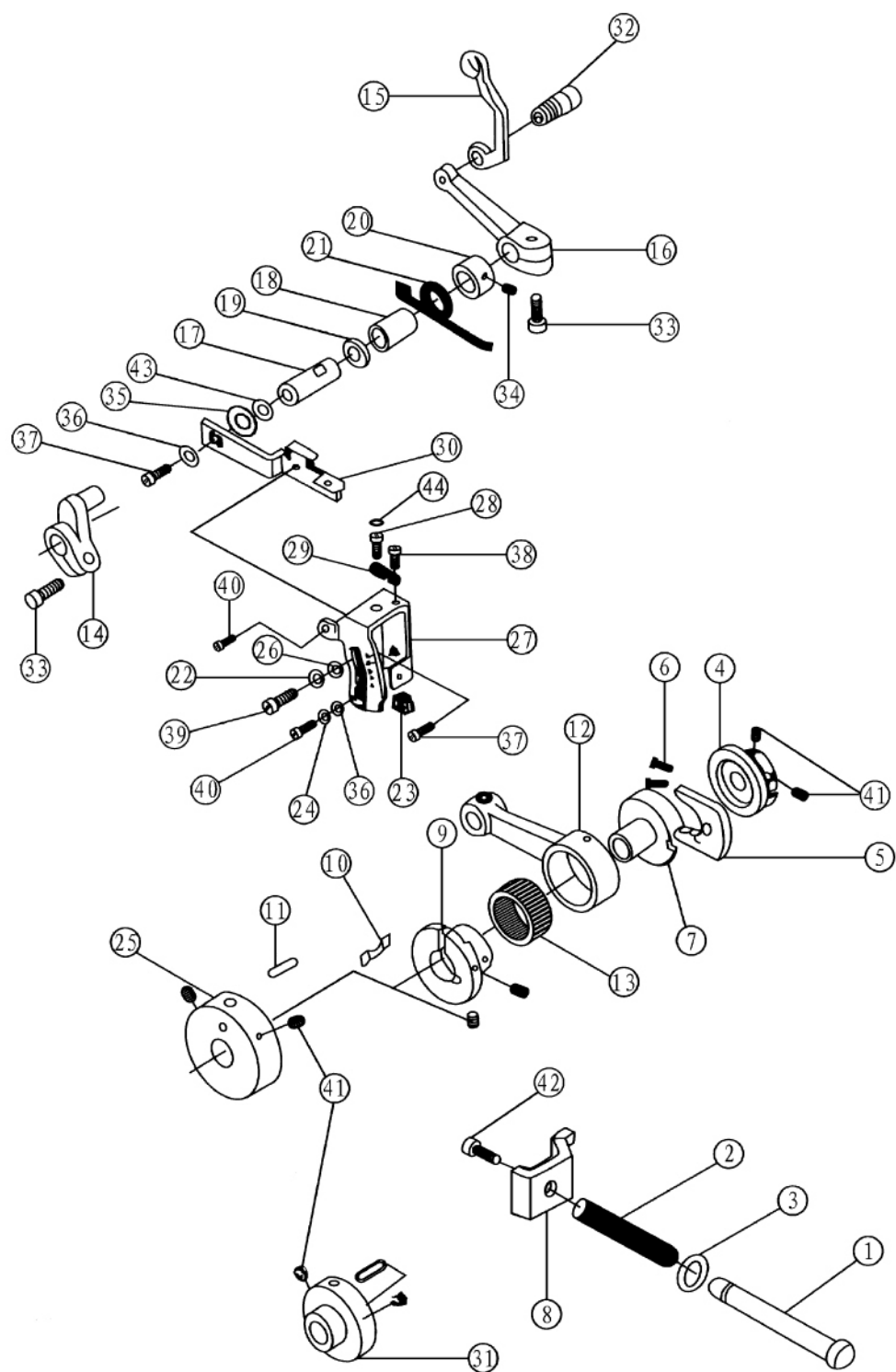

Different Feed Assemblies

NO.	Part NO.	Ref.Part NO.	Description	(Number)		
				Three-thread	Four-thread	Five-thread
1	20102011	KP01	Stitch length regulating shaft	1	1	1
2	20127008	KP02	Spring	1	1	1
3	O01016	KP03	Oil washer	1	1	1
4	2011000100	KP05D	Stitch length regulation cam asm	1	1	1
5	20109004	KP06D	Stitch length regulating block	1	1	1
6	20127009	KP08	Stitch length regulating block spring	2	2	2
7	20110002	KP09D	Stitch length cam	1	1	1
8	20112034	KP11	Stitch length regulating plate	1	1	1
9	20110003	KP13D	Feed length cam	1	1	1
10	20112035	KP15	Feed cam spring	1	1	1
11	P01004	KP18-1	Feed cam pin	1	1	1
12	20105004	KP21	Feed link	1	1	1
13	B07007	KP22	Feed rod rolling pin bearing	1	1	1
14	20104015	KP23	Feed crank	1	1	1
15	20105005	KP25	Differential link	1	1	1
16	20104016	KP28	Differential crank	1	1	1
17	20102012	KP30B	Differential shaft	1	1	1
18	20103017	KP31	Differential shaft bearing	1	1	1
19	20122029	KP32	Oil seal	1	1	1
20	20108005	KP34	Snap ring	1	1	1
21	20127010	KP35D	Spring	1	1	1
22	201S16008	KP39	Washer	1	1	1
23	20109005	KP43	Regulating block	1	1	1
24	20128027	KP46	Washer	1	1	1
25	20110004	KP59	Feed bam	1	1	0
26	20128028	KP60	Washer	1	1	1
27	20112036	KP62	Differential regulation holder	1	1	1
28	201S30013	KP63	Regulating screw	1	1	1
29	20127011	KP64	Regulating screw spring	1	1	1
30	20112037	KP65B	Differential regulating link	1	1	1
31	2010402300	KP18-2	Crank link cam	0	0	1
32	201S20008	SK452	Differential link screw	1	1	1
33	201S13003	SK612	Differential crank screw	2	2	2
34	201S12002	SK251	Snap ring screw	1	1	1
35	20128024	WK24	Washer	1	1	1
36	W01006	WK01	Washer	2	2	2
37	201S11016	SK262	Differential position screw	1	1	1
38	201S11005	SK221	Spring screw	1	1	1
39	201S30005	SK399	Differential regulating screw	1	1	1
40	201S11018	SK262	Differential regulating screw	1	1	1
41	201S14002	SK215	Screw	4	4	4
42	201S12005	SK261	Screw	1	1	1
43	20122038	--- ---	Washer	1	1	1
44	20137004	--- ---	Mard plate	1	1	1

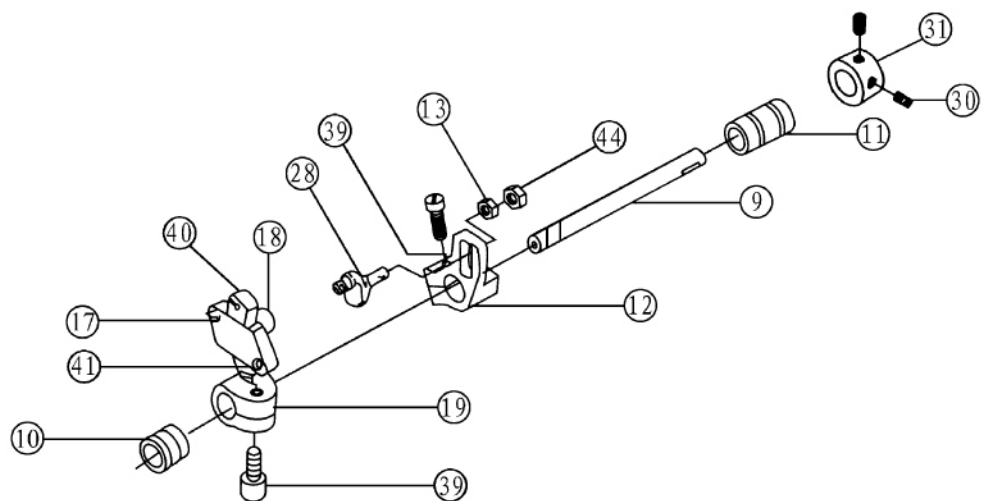
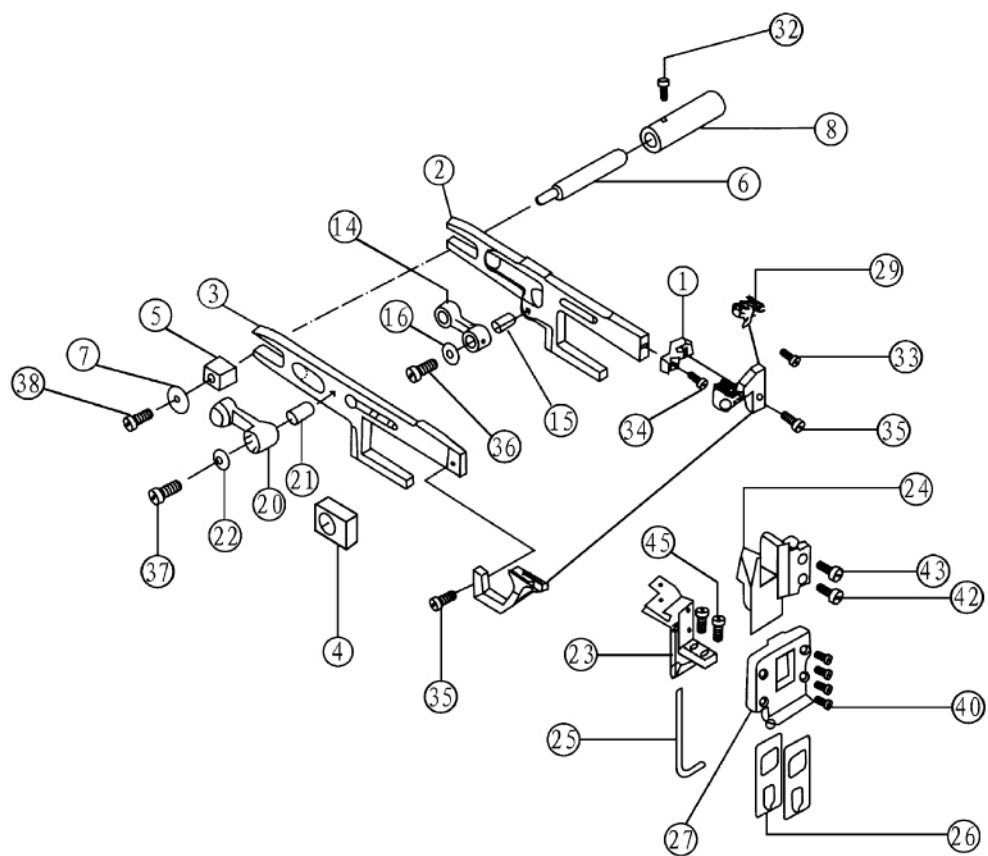

Feed Dog Assemblies

NO.	Part NO.	Ref.Part NO.	Description	(Number)		
				Three-thread	Four-thread	Five-thread
1	20109006	KQ05	Dog link plate	1	1	1
2	20106001	KQ07	Feed dog holder	1	1	1
3	20106002	KQ10	Differential feed dog holder	1	1	1
4	20109007	--- ---	Feed dog lift slide block	1	1	1
5	20109008	KQ14	Differential feed slide block	1	1	1
6	20102013	KQ15	Slide block eccentric shaft	1	1	1
7	20112038	KQ17	Slide block eccentric washer	1	1	1
8	20103018	KQ19	Slide block eccentric shaft bushing	1	1	1
9	20102014	KQ21	Feed shaft	1	1	1
10	20103019	KQ24	Left feed shaft bushing	1	1	1
11	20103020	KQ25	Right feed shaft bushing	1	1	1
12	20104017	KQ28	Feed regulating crank	1	1	1
13	20128021	KQ31	Washer	1	1	1
14	20105006	KQ33	Feed dog holder link	1	1	1
15	20103021	KQ34	Feed dog holder link bushing	1	1	1
16	20128029	KQ35	Differential feed dog holder link bushing	1	1	1
17	20112039	KQ37-1	Crank slide block cover	1	1	1
18	20109010	KQ37-2	Crank slide block	1	1	1
19	20104018	KQ37-3	Feed regulating crank	1	1	1
20	20105007	KQ40	Differential feed dog holder link	1	1	1
21	20103022	KQ41	Differential feed dog holder link bushing	1	1	1
22	20128030	KQ42	holder link bushing washer	2	2	2
23	20101023	KQ46D	Screw oil plate	1	1	1
24	20109011	KQ47	Feed dog carrier connection rod	1	1	1
25	20122030	KQ48	Sealing connecting ring	1	1	1
26	20122031	KQ49	Adjustable oil seal	2	2	2
27	20109012	KQ50	Sealing connecting rod	1	1	1
28	20102015	KQ90	Feed dog link eccentric shaft	1	1	1
29	2011401700	--- ---	Feed form	1	1	0
	2011401800	--- ---	Feed form	1	0	0
	2011401900	--- ---	Feed form	0	0	1
	2011402000	--- ---	Feed form	0	0	1
30	201S15003	SK293	Snap ring screw	2	2	2
31	20108002	KF21	Snap ring	1	1	1
32	201S12002	SK251	Screw	1	1	1
33	201S11003	SK209	Screw	1	1	1
34	201S11012	SK241	Screw	1	1	1
35	201S11038	SK576	Main feed dog screw	2	2	2
36	201S12003	SK253	Screw	1	1	1
37	201S12004	--- ---	Screw	1	1	1
38	201S17003	SK212	Screw	1	1	1
39	201S13003	SK612	Crank screw	2	2	2
40	201S11005	SK221	Crank screw	4	4	4
41	201S11032	SK343	Crank slide block screw	2	2	2
42	201S11018	SK262	Tooth rocks screw II	1	1	1
43	201S11023	SK277	Tooth rocks screw I	1	1	1
44	201S16002	NK25	Nut	1	1	1
45	201S11016	SK257	Screw	2	2	2

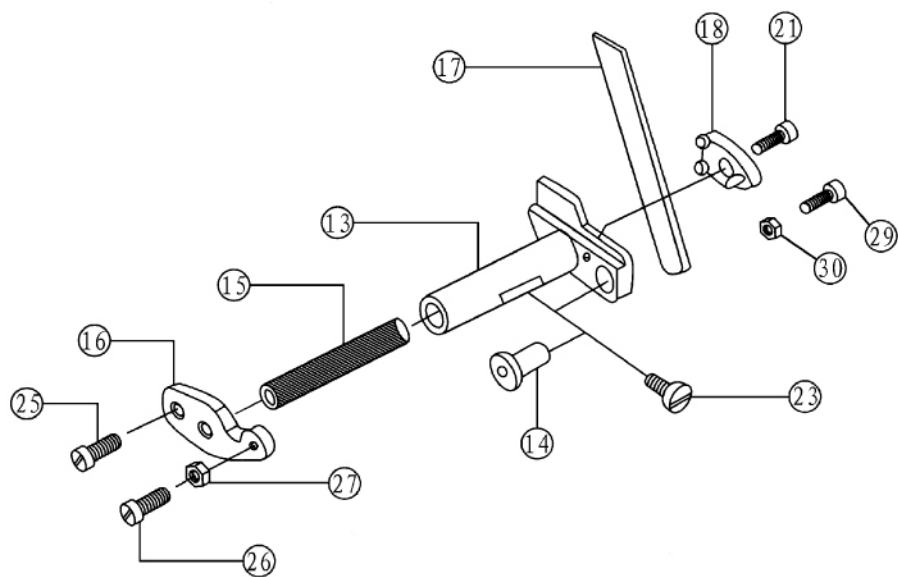
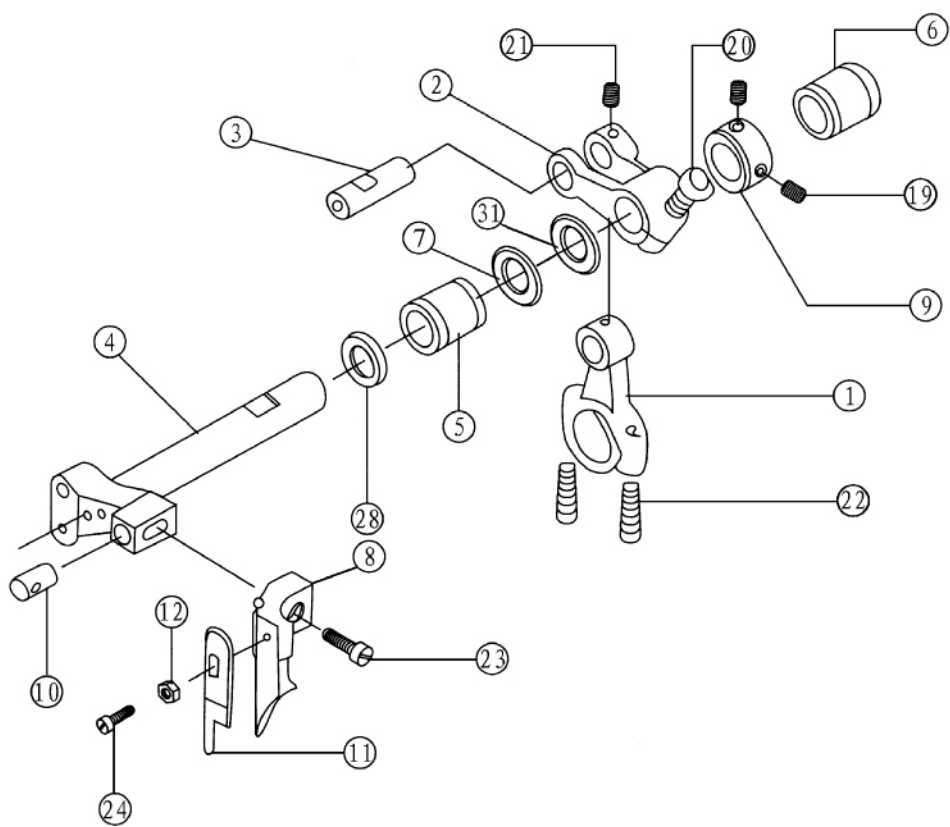

Trimming Assemblies

NO.	Part NO.	Ref.Part NO.	Description	(Number)		
				Three-thread	Four-thread	Five-thread
1	20105008	KR01	Upper knife driving connecting link	1	1	1
2	20104019	KR04	Upper knife crank	1	1	0
	20104020	KR03	Upper knife crank	0	0	1
3	20126015	KR07	Crank pin	1	1	1
4	20102017	KR09	Upper knife frame rock shaft	1	1	1
5	20103023	KR12	Left shaft bushing	1	1	1
6	20103024	KR13	Right shaft bushing	1	1	1
7	20128031	KR14	Washer	1	1	1
8	20101024	KR20	Upper knife holder	1	1	0
	20101025	KR19	Upper knife holder	0	0	1
	20101053	--- ---	Upper knife holder	0	0	1
9	20108002	KR21	Snap ring	1	1	1
10	20126016	KR22	Upper knife holder pin	1	1	1
11	20119001	KR23	Upper knife	1	1	1
	20119005	--- ---	Upper knife	0	0	1
12	20128020	WK09	Washer	1	1	1
13	20102018	KR27	Lower knife holder	1	1	0
	20102019	KR26	Lower knife holder	0	0	1
	20102023	--- ---	Lower knife holder	1	1	0
14	20103025	KR29	Lower knife holder bushing	1	1	1
15	20127012	KR32	Lower knife holder spring	1	1	1
16	20112040	KR33	Lower knife holder	1	1	1
17	20119002	KR35	Lower knife	1	1	1
	20119006	--- ---	Lower knife	0	0	1
18	20101026	KR36	Lower knife holder lock plate	1	1	1
19	201S15003	SK293	Snap ring screw	2	2	2
20	201S13003	SK612	Upper knife crank set screw	1	1	1
21	201S12005	SK270	Upper knife crank pin screw	2	2	2
22	201S20006	SK385	Connecting link screw	2	2	2
23	201S11022	SK277	Upper knife holder screw	2	2	2
24	201S12001	SK246	Upper knife screw	1	1	1
25	201S11017	SK262	Lower knife snap plate screw	1	1	1
26	201S11012	SK241	Lower knife snap plate screw	1	1	1
27	201S16001	NK23	Lower knife snap plate screw	1	1	1
28	20122038	KF19	Oil seal	1	1	1
29	201S11015	SK256	Lower knife holder screw	1	1	1
30	W01006	KQ35	Washer	1	1	0
	20128025	--- ---	Washer	0	0	1
31	20628014	KR14	Washer	1	1	1

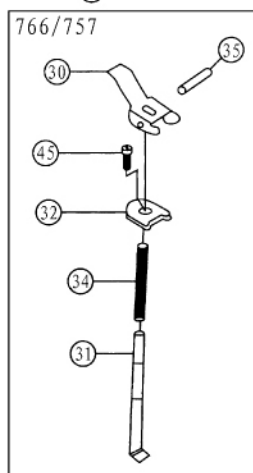
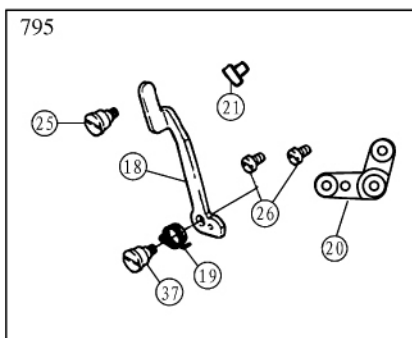
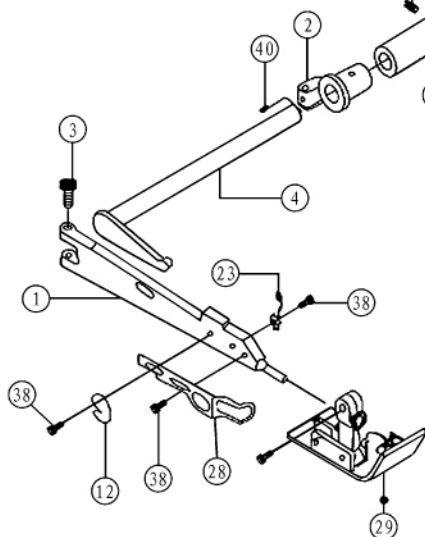
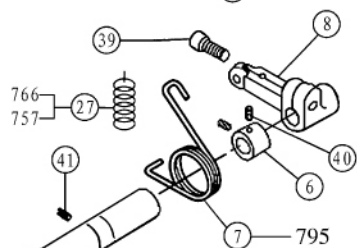
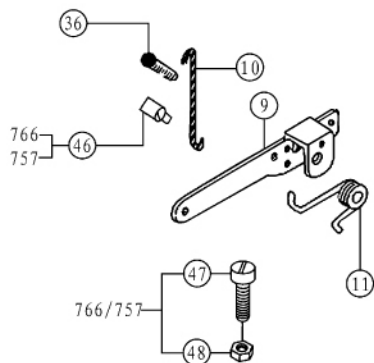
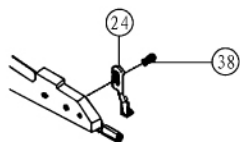
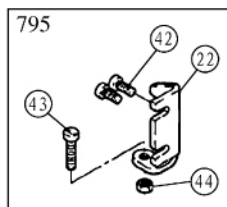

Presser foot Assemblies

NO.	Part NO.	Ref.Part NO.	Description	(Number)		
				Three-thread	Four-thread	Five-thread
1	20101027	KS01	Presser foot holder	1	1	1
2	20103026	KS02D	Presser foot shaft bushing	1	1	1
3	201S11004	KS03	Screw	1	1	1
4	20102020	KS09	Presser foot holder shaft	1	1	1
5	20103027	KS10D	Presser foot shaft bushing	1	1	1
6	20108006	KS12	Presser foot shaft snap ring	1	1	1
7	20127013	KP35D	Presser foot lifting spring	1	1	1
8	20104021	KS14F	Presser foot crank	1	1	1
9	20112041	KS18	Presser foot lifting lever	1	1	1
10	20126018	KS20	Hook	1	1	1
11	20127014	KS21	Spring	1	1	1
12	20119003	KS24	Thread cutting knife	1	1	1
13	20102021	KS26-2D	Presser bar	1	1	1
14	20127015	KS27	Presser bar spring	1	1	1
15	201S30014	KS28	Presser bar screw	1	1	1
	203S30001	KS28	Presser bar screw	1	1	1
16	203S20001	SK439	Screw	1	1	1
	201S20009	--- ---	Screw	1	1	1
17	20611006	274013	Presser bar shockproof block	1	1	1
18	20112074	--- ---	Presser foot lifting handle	1	1	1
19	20627010	274017	Presser foot lifting handle spring	1	1	1
20	20101052	--- ---	Presser foot lifting handle restricter	1	1	1
21	30122018	240123	Washer	1	1	1
22	20612031	209676	Presser foot corner plate	1	1	1
23	20127016	KS44	Presser foot spring	0	0	1
24	20112042	KS54	Presser foot holder connection plate	1	1	0
25	206S20007	--- ---	Screw	1	1	1
26	S02003	S157	Screw	2	2	2
27	20327001	KS13	Presser foot lifting spring	1	1	1
28	20112045	KS65	Presser foot holder cover	1	1	1
29	20116001	P253E-3	Presser foot form	1	0	0
	20116002	P253E-4	Presser foot form	0	1	0
	20116003	P504-A	Presser foot form	0	0	1
	20116006	--- ---	Presser foot form	1	0	0
	20116007	--- ---	Presser foot form	0	0	1
	20516015	--- ---	Presser foot form	0	0	1
	20116004	--- ---	Presser foot form	1	0	0
	20116005	--- ---	Presser foot form	0	1	0
30	20312001	KS29	Presser foot lifting handle	1	1	1
31	20326001	KS30D	Presser foot lifting anh	1	1	1
32	20312002	KS31E	Presser foot lifting handle bracket	1	1	1
33	20103028	KS32	Presser bar bushing	1	1	1
34	20327002	KS34	Presser foot lifting spring	1	1	1
35	P03028	--- ---	Pin	1	1	1
36	201S20004	SK296	Set screw	1	1	1
37	201S30020	--- ---	Lifting handle screw	1	1	1
38	201S11005	SK221	Screw	3	3	3
39	201S12007	SK298	Crank set screw	1	1	1
	201S13003	--- ---	Crank set screw	1	1	1
40	S10005	005292-HV	Snap washer screw	3	3	3
41	201S14002	--- ---	Screw	1	1	1
42	201S11016	SK257	Set plate screw	2	2	2
43	S01023	7175	Screw	1	1	1
44	206S16005	--- ---	Nut	1	1	1
45	201S11035	SK408	Screw	1	1	1
46	203S30002	SK255	Screw	1	1	1
47	203S12001	SK331	Screw	1	1	1
48	201S16003	NK26	Nut	1	1	1

795

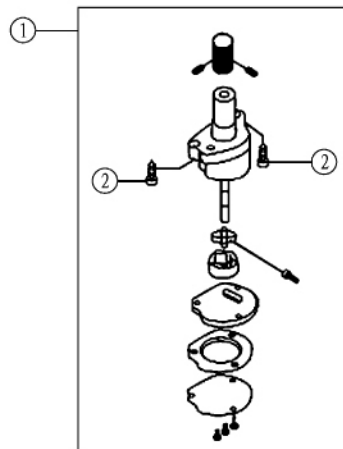
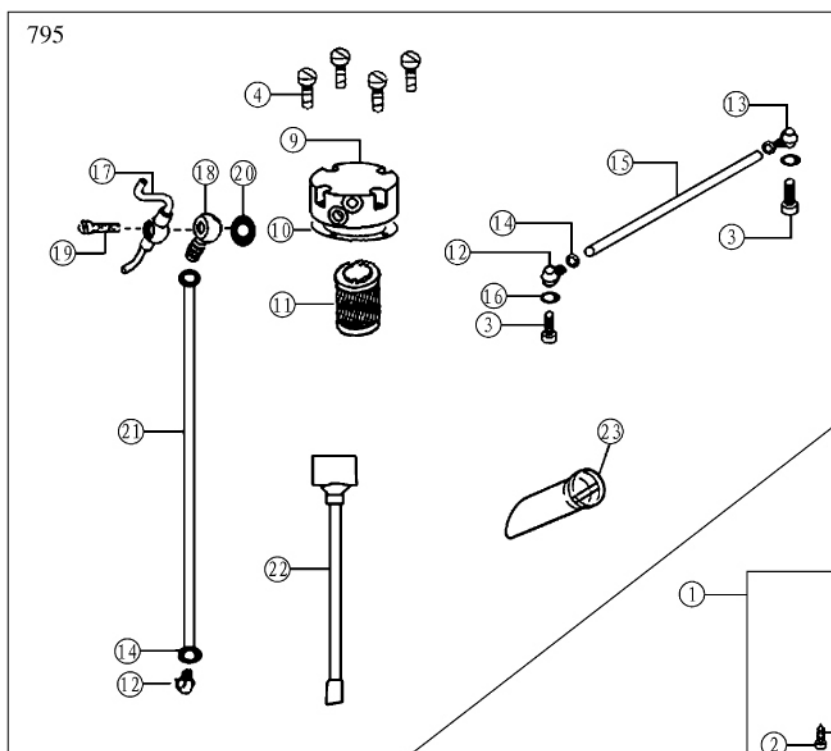

766/757

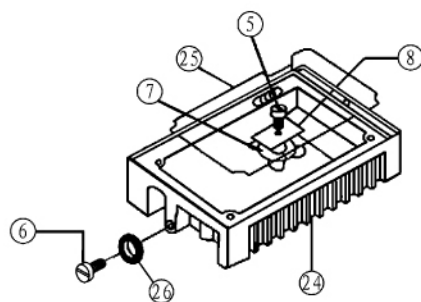
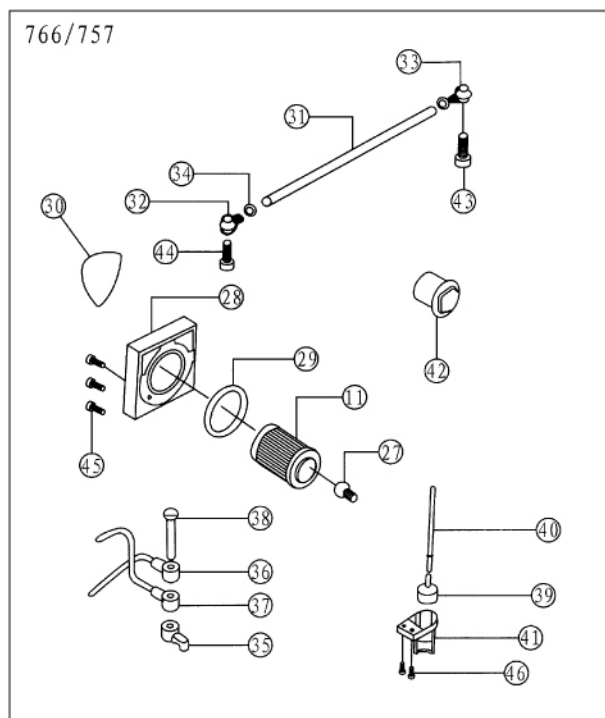

Lubrication Assemblies

NO.	Part NO.	Ref.Part NO.	Description	(Number)		
				Three-thread	Four-thread	Five-thread
1	20120001	--- ---	Oil pump	1	1	1
	20320001	--- ---	Oil pump	1	1	1
2	201S11025	SK278	Oil pump screw	2	2	2
3	201S30004	SK304	Oil tube joint screw	4	4	4
4	209S11019	--- ---	Oil screen cover screw	4	4	4
5	201S11019	SK265	Oil pan magnet cover screw	1	1	1
6	201S11031	SK310	Oil pan screw	1	1	1
7	10131001	--- ---	Oil pan magnet	1	1	1
8	20112050	KT58	Oil pan magnet cover	1	1	1
9	20101034	--- ---	Oil clearer cover	1	1	1
10	20122032	--- ---	Oil clearer cover seal ring	1	1	1
11	20136001	KT14-A	Oil clearer	1	1	1
12	20136002	--- ---	Oil tube joint I	2	2	2
13	20136003	--- ---	Oil tube joint II	1	1	1
14	20129002	--- ---	Oil tube shape ring	4	4	4
15	2012100600	--- ---	Oil tube	1	1	1
16	20122034	--- ---	Washer	3	3	3
17	20136004	--- ---	Double node oil manager	1	1	1
	20121012	--- ---	Double node oil manager	1	1	1
18	20136005	--- ---	Oil tube joint	1	1	1
19	201S30015	--- ---	oil manager screw	1	1	1
20	20122033	--- ---	Washer	4	4	4
21	2012100700	--- ---	Oil tube	1	1	1
22	20121016	KA38	Oil back tube	1	1	1
23	20111010	--- ---	Oil observer	1	1	1
24	20101035	KT51B	Oil pan	1	1	1
25	20122035	KT52B	Oil pan washer	1	1	1
26	20122036	KT56	Oil seal	1	1	1
27	20121013	--- ---	Oil cljerner joint	1	1	1
28	300077	KT16	Oil screen cover	1	1	1
29	20322004	KT17	Oil clerner cover seal ring	1	1	1
30	20337005	KT18	ingicaing plat	1	1	1
31	2032100400	--- ---	Oil clearer cover	1	1	1
32	20136002	--- ---	Oil tube joint I	1	1	1
33	20136003	--- ---	Oil tube joint II	1	1	1
34	30129003	202199	Oil tube shap ring	1	1	1
35	20301006	KT38	Lubrcate bushing	1	1	1
36	20321002	KT22	Upper screem	1	1	1
37	20321003	KT39-2	lower screem	1	1	1
38	203S30004	SK286	Oil screem screw	1	1	1
39	20311005	KT46E	Oil show bracket	1	1	1
40	20311006	KT47E	Oil show cleaner link	1	1	1
41	20312003	KT49D	Oil show cleaner guard	1	1	1
42	20311008	KT74	Oil dial	1	1	1
43	203S30003	SK419	Screw	1	1	1
44	201S30004	SK304	Screw	1	1	1
45	201S11019	SK265	Screw	3	3	3
46	201S11014	SK250	Screw	2	2	2

Feed Snap Assemblies

NO.	Part NO.	Ref.Part NO.	Description	(Number)		
				Three-thread	Four-thread	Five-thread
1	20123012	KU02	Oil seal	1	1	1
2	20101037	KU14	Needle cooler	1	1	0
	20101038	KU15	Needle cooler	0	0	1
3	20121019	KU20	Oil tube backer	1	1	1
4	20123021	KU22	Oil wick	1	1	1
5	20111011	KU23-1B	Lower oil box cover	1	1	1
6	20111012	KU23-2B	Lower oil box	1	1	1
7	20123014	KU24	Oil felt	1	1	0
	20123015	KU25	Oil felt	0	0	1
8	20123021	KU26	Oil wick	1	1	1
9	20112051	KU27D	Cloth guide holder	1	1	1
10	20112052	KU28D	Hinge plate	1	1	1
11	20123017	KU29	Oil felt block	1	1	1
12	20126020	KU34	Hinge pin	1	1	1
13	20112053	KU35	Hinge spring	1	1	1
14	20112054	KU40	Snap plate	1	1	0
	20112055	KU39	Snap plate	0	0	1
	20112071	--- ---	Snap plate	1	1	0
15	20112056	KU43	Snap plate bracket	1	1	1
16	201S11009	SK233	Screw	1	1	1
17	20128020	WK09	Washer	3	3	3
18	201S11011	SK239	Hinge spring screw	1	1	1
19	201S12001	SK246N	Hinge screw	2	2	2
20	201S16003	NK26	Nut	1	1	1
21	201S11016	SK277N	Cloth guide holder screw	1	1	1
22	201S11018	SK262	Needle cooler screw	3	3	3
23	201S20002	SK266	Cloth guide holder screw	1	1	1
24	20128027	KP46	Washer	1	1	1
25	20129002	KT26	Oil tube shape ring	2	2	2

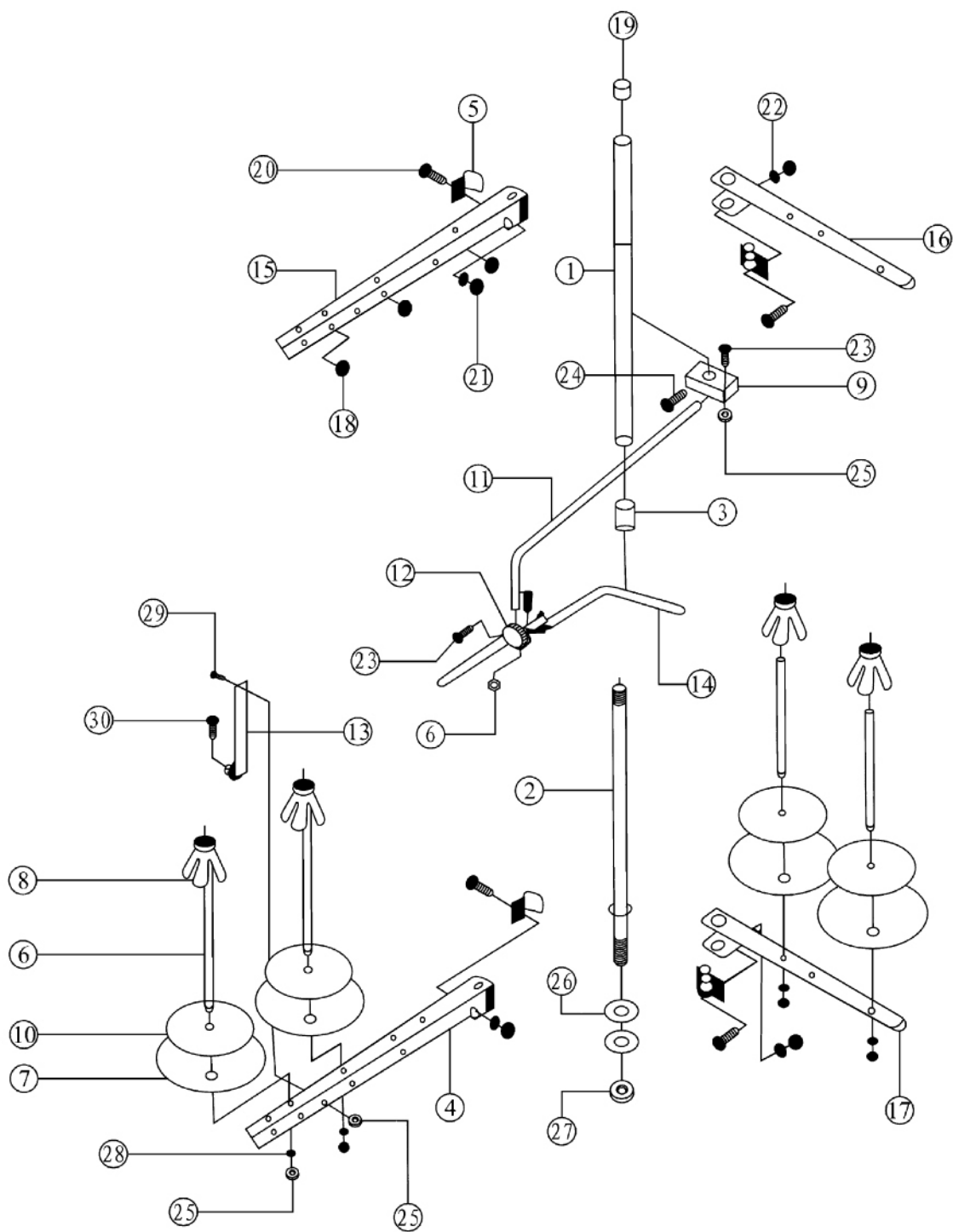

Thread Spool Assemblies

NO.	Part NO.	Ref.Part NO.	Description	(Number)		
				Three-thread	Four-thread	Five-thread
1	20131001	KW01E	Upper thread column	1	1	1
2	20131002	KW02E	Lower thread column	1	1	1
3	20131003	KW03E	Bushing	1	1	1
4	20131004	KW04E	Long thread spool troy bracket	1	1	1
5	20131005	KW05E	Thread guide hook	4	4	4
6	20131006	KW09B	Spool pin	3	4	5
7	20131007	KW12E	Spool tray	3	4	5
8	20131008	KW13E	Centering device	3	4	5
9	20131009	KW14E	Clamp plate	1	1	1
10	20131010	KW28E	Spool tray cushioning	3	4	5
11	20131011	KW16	Thread guide connecting bar	1	1	1
12	20131012	KW20E	Thread guide joint	1	1	1
13	20131013	KW22	Thread stable holder	1	1	1
14	20131014	KW23	Thread guide bar	1	1	1
15	20131015	KW26E	Thread spool tray bracket	1	1	1
16	20131016	KW28E	Thread guide plate	1	1	1
17	20131017	KW29E	Thread spool tray bracket	1	1	1
18	20131018	KW32E	Thread guide hook	3	3	3
19	20131019	KW3613	Rubber seal	1	1	1
20	20131020	SK421	Thread guide hook screw	4	4	4
21	201S16006	NK31B	Thread guide hook nut	4	4	4
22	20128016	SW01	Thread guide washer	4	4	4
23	20131021	SK386B	Clamp plate screw	3	3	3
24	20131022	SK281B	Clamp holder screw	1	1	1
25	201S16004	NK29B	Nut	8	8	8
26	20128025	KW25B	Lower washer	2	2	2
27	201S16005	NK30	Nut	1	1	1
28	20128018	SW04	Washer	4	4	4
29	20131023	SK420	Thread stand holder screw	1	1	1
30	20131024	SK422	Thread stand holder join screw	1	1	1

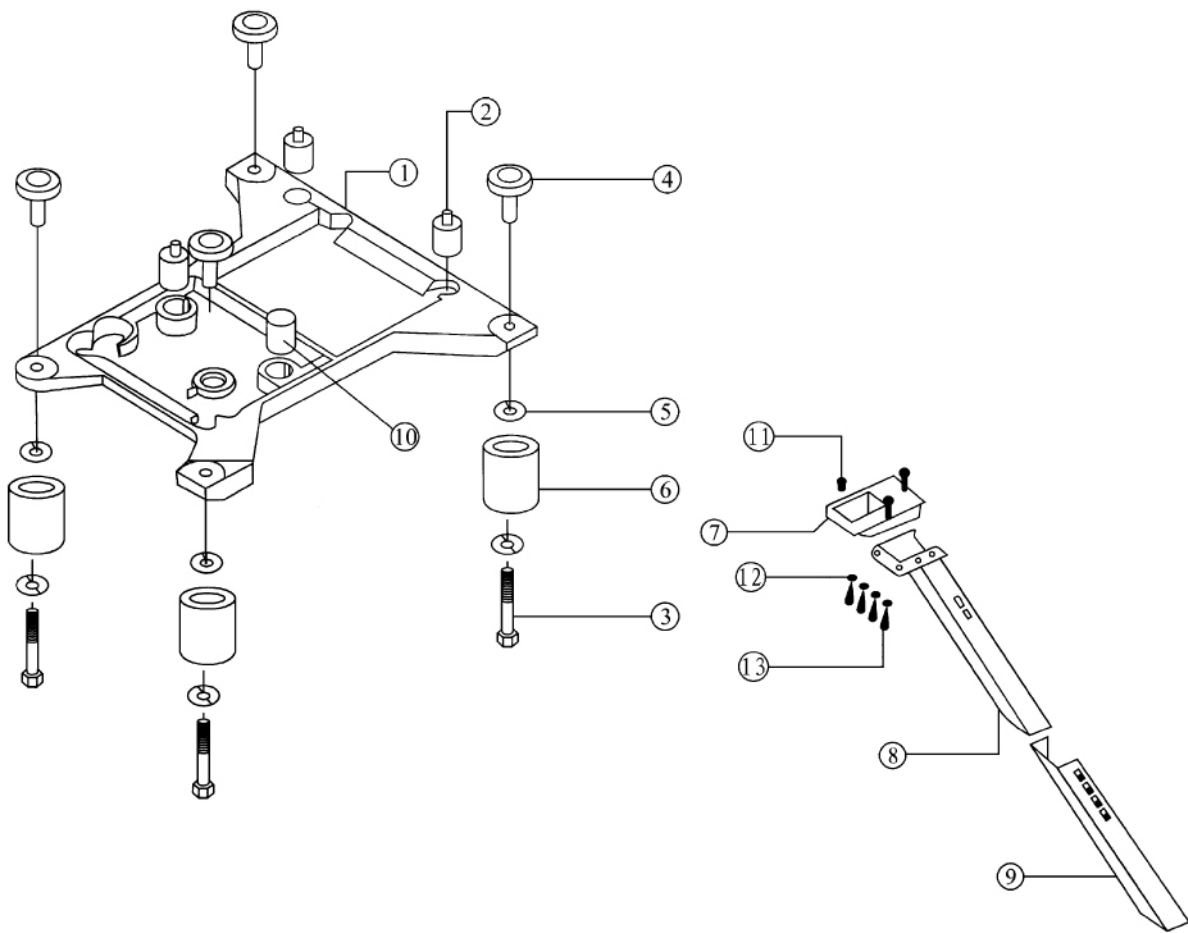
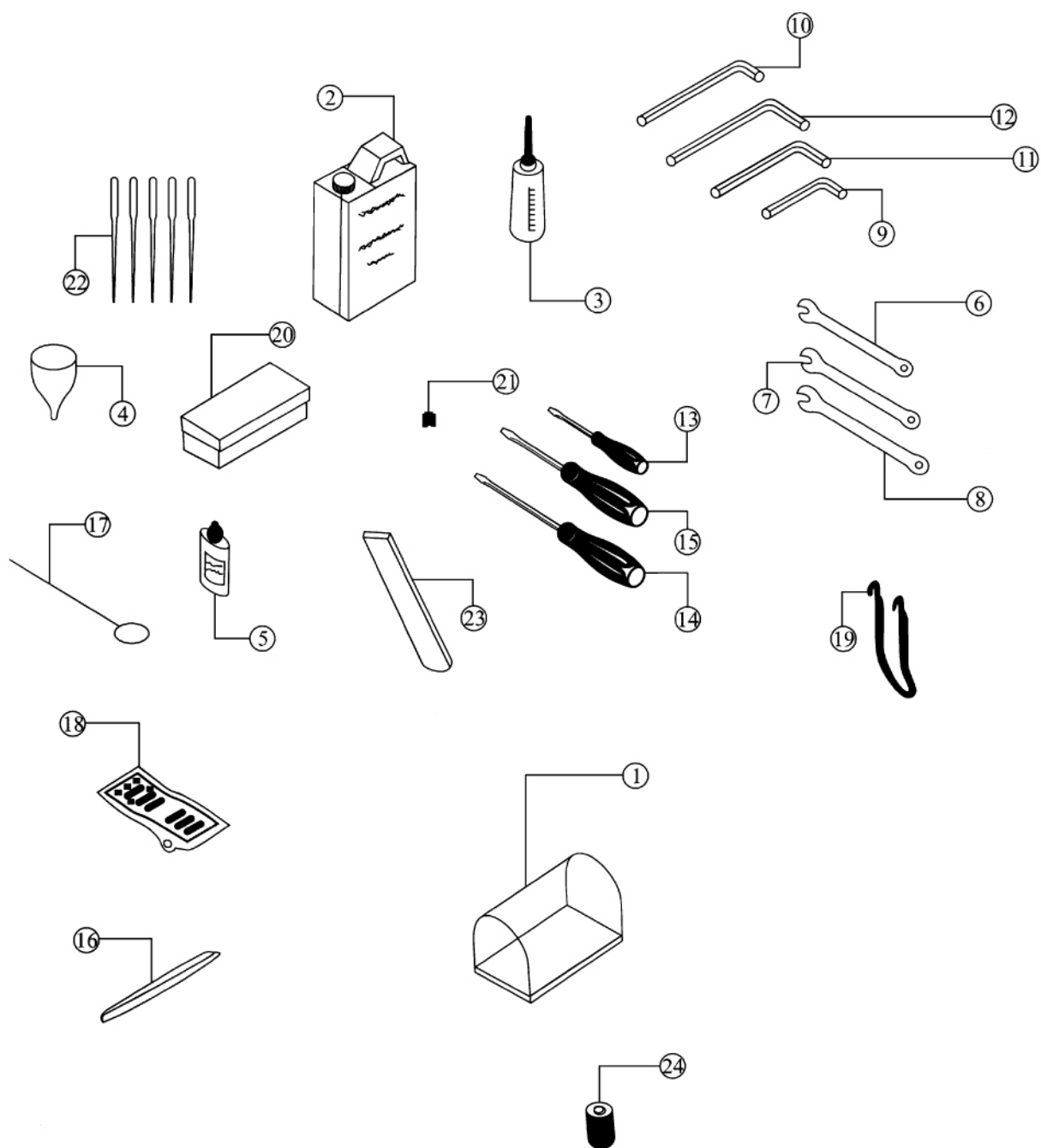











Plate Row Material Assemblies

NO.	Part NO.	Ref.Part NO.	Description	(Number)		
				Three-thread	Four-thread	Five-thread
1	20131025	KX01	Machine head plate	1	1	1
2	20131026	KX02	Head shockproof cushion	3	3	3
3	20131027	KX04	Screw	4	4	4
4	20131028	KX05	Screw	4	4	4
5	20131029	KX08	Big washer	12	12	12
6	20131030	KX09	Plate dog link bushing	12	12	12
7	20131031	KX10E	Row material trollgh bracket	1	1	1
8	20131032	KX12E	Row material trough I	1	1	1
9	20131033	KX13E	Row material trough II	1	1	1
10	20131057	--- ---	Washer	1	1	1
11	20131034	SK391	Row material seat screw	3	3	3
12	20128022	WK21	Row material washer	4	4	4
13	20131035	SK392	Row material screw	4	4	4



Accessories Assemblies

NO.	Part NO.	Ref.Part NO.	Description	(Number)		
				Three-thread	Four-thread	Five-thread
1	20131036	KY01	Machine head cover	1	1	1
2	20131037	KY02	Oil can/100cc	1	1	1
3	20131038	KY03	Notes oil	1	1	1
4	20131039	KY04	Tundish	1	1	1
5	20131040	KY05	Oil can/50cc	1	1	1
6	20131041	KY07	Spanner	1	1	1
7	20131042	KY08	Spanner	1	1	1
8	20131043	KY09	Spanner	1	1	1
9	20131044	KY10	Inner-hexagon screw driver	1	1	1
10	20131045	KY11	Inner-hexagon screw driver	1	1	1
11	20131046	KY12	Inner-hexagon screw driver	1	1	1
12	20131047	KY13	Inner-hexagon screw driver	1	1	1
13	20131048	KY14	screw driver	1	1	1
14	20131049	KY15	screw driver	1	1	1
15	20131050	KY16	screw driver	1	1	1
16	20131051	KY18	Tweezer	1	1	1
17	20131052	KY19	Metal guide	0	0	1
18	20131053	KY20D	Presser foot base	1	1	1
19	20131054	KY21-A	Presser foot base chain	1	1	1
20	20131055	KY26	Attachment box	1	1	1
21	201S14001	SK216	Thumble screw	4	4	4
22	20117001	DCX27	Needle	4	4	4
23	20119002	KR35	Lower knife	1	1	1
	20119006	--- ---	Lower knife	0	0	1
24	20136001	KT14-A	Oil filter	1	1	1

795、757、766											
											
MACHINE TYPE/SPEC	GAUGE		NEEDLE PLATE	FEED FORM	PRESSER FOOT ASSM.	UPPER LOOPER	NEEDLE CLAMP	WASHER	CRANK	LOWER LOOPER CRANK	NEEDLE
	NG	SW									
795-3-504M1-15 757/766-3-504M1-15	0	1.5	20115006	2011401800	20116006	20117007	20134002	20128006	20104003	20104009	DC27# 11
795-3-504M2-04 757/766-3-504M2-04	0	4	20115001	2011401700	20116001	20117007	20134002	20128006	20104003	20104009	DC27# 11
795-3-504M5-04/BK 737/766-3-504M5-04/BK	0	4	20115004	2011402100	20116004	20117007	20134002	20128006	20104003	20104009	DC27# 11
795-3-504M2-04/LFC-2 737/766-3-504M2-04/LFC-2	0	4	20115001	2011401700		20117007	20134002	20128006	20104003	20104009	DC27# 11
795-4-514M2-24/LFC-2 747/766-4-514M2-24/LFC-2	2	4	20115002	2011401700		20117007	20134001	20128005	20104002	20104009	DC27# 11
795-4-514M5-23/BK 747/766-4-514M5-23/BK	2	3	20115005	2011402100	20116005	20117007	20134001	20128005	20104002	20104009	DC27# 11
795-4-514M2-24 757/766-4-514M2-24	2	4	20115002	2011401700	20116002	20117007	20134001	20128005	20104002	20104010	DC27# 11
795-5-516M2-35 757/766-5-516M2-35	3	5	20115003	2011401900	20116003	20117007	20134003	20128005	20104002	20104010	DC27# 14
795-5-516M2-55 757/766-5-516M2-55	5	5	20115008	2011401900	20116007	20117007	20134004	20128005	20104002	20104010	DC27# 14
795-5-516X2-56 757/766-5-516X2-56	5	6	20115007	2011402000	20516015	20117007	20134004	20128005	20104002	20104010	DC27# 19